



Colorado Convention Center

Overview

Terrace Level

- Opening Reception
- Teacher Voices Keynote

Level 2

- Expo Hall
- Job Fair
- Registration
- NSTA Café
- NSTA Hub
- Poster Sessions
- Scooter Rental Pick-Up
- Shar-a-thons
- Volunteer Check-In

Level 3

- First-Timers Session
- Gender Neutral/Family Restrooms
- Keynote Sessions
- Professional Learning Institutes (PLIs)
- Short Course

Lower Level

Expo Hall

- Expo Hall Map
- Job Fair
- Registration
- NSTA Café
- NSTA Hub
- Poster Sessions
- Share-a-thons

Hyatt Regency Hotel

Level 3

- High School Haven

Level 4

- Leaders Institute

Local Area

Hotel Locations

- AC Hotel Denver
- Aloft Denver Downtown
- Embassy Suites by Hilton
- Hilton Denver City Center
- Homewood Suites
- Hyatt House Denver Downtown
- Hyatt Place Denver Downtown
- Hyatt Regency Denver at Colorado Convention Center
- Le Meridien Denver Downtown
- Magnolia Hotel Denver
- Sheraton Denver Downtown
- Sonesta Denver Downtown
- The Curtis – a DoubleTree by Hilton

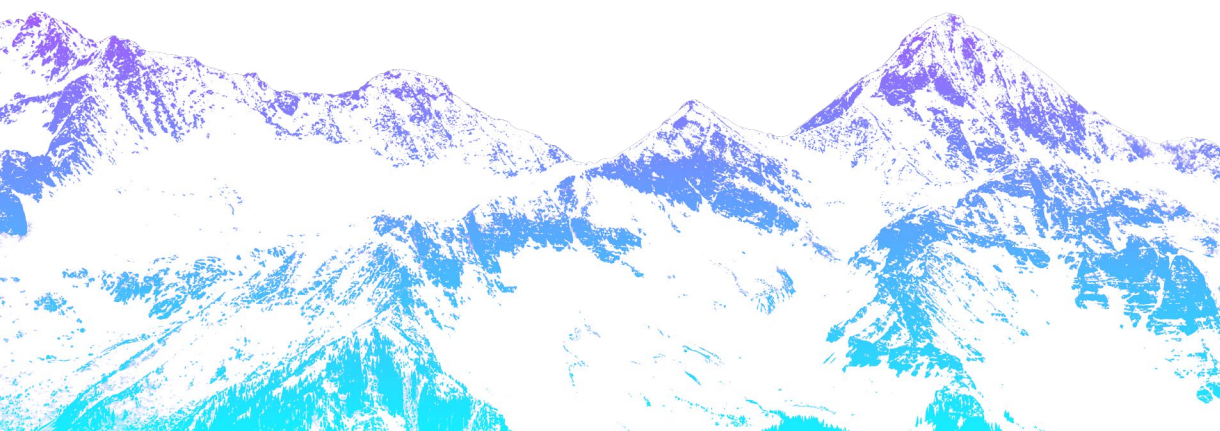

Colorado Convention Center

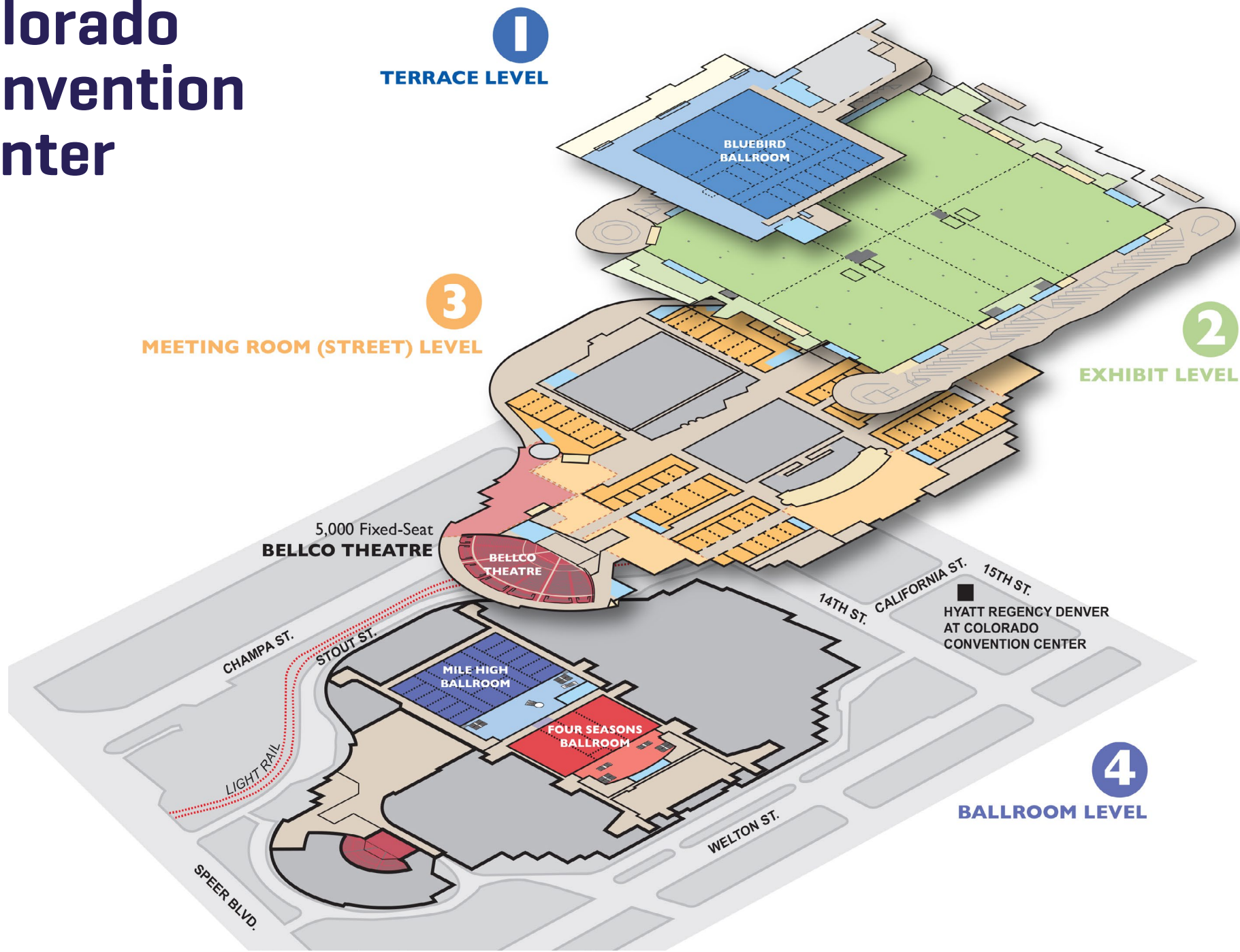

Terrace Level

[Click here to return to Points of Interest](#)

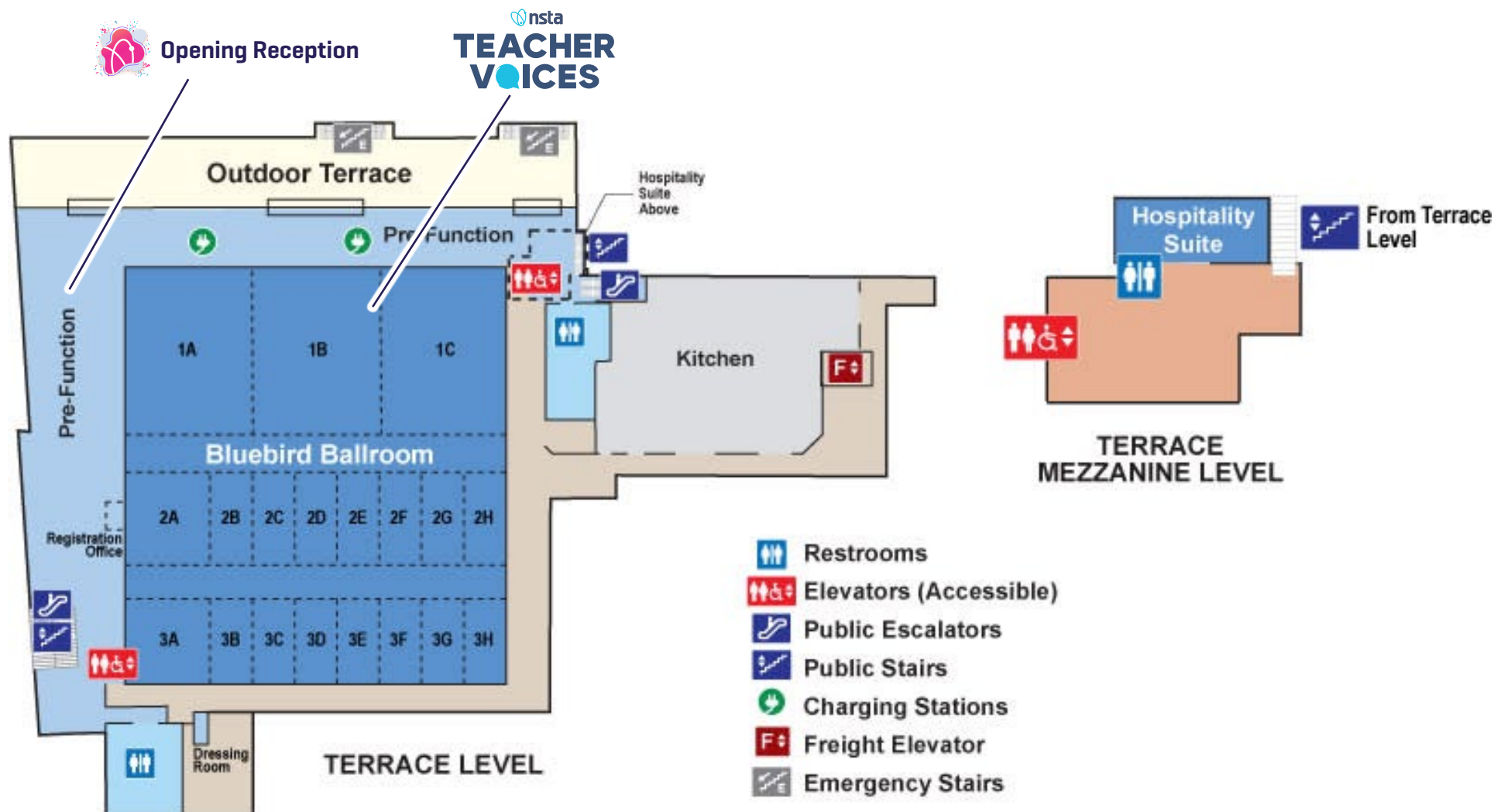

Level 2

[Click here to return to Points of Interest](#)

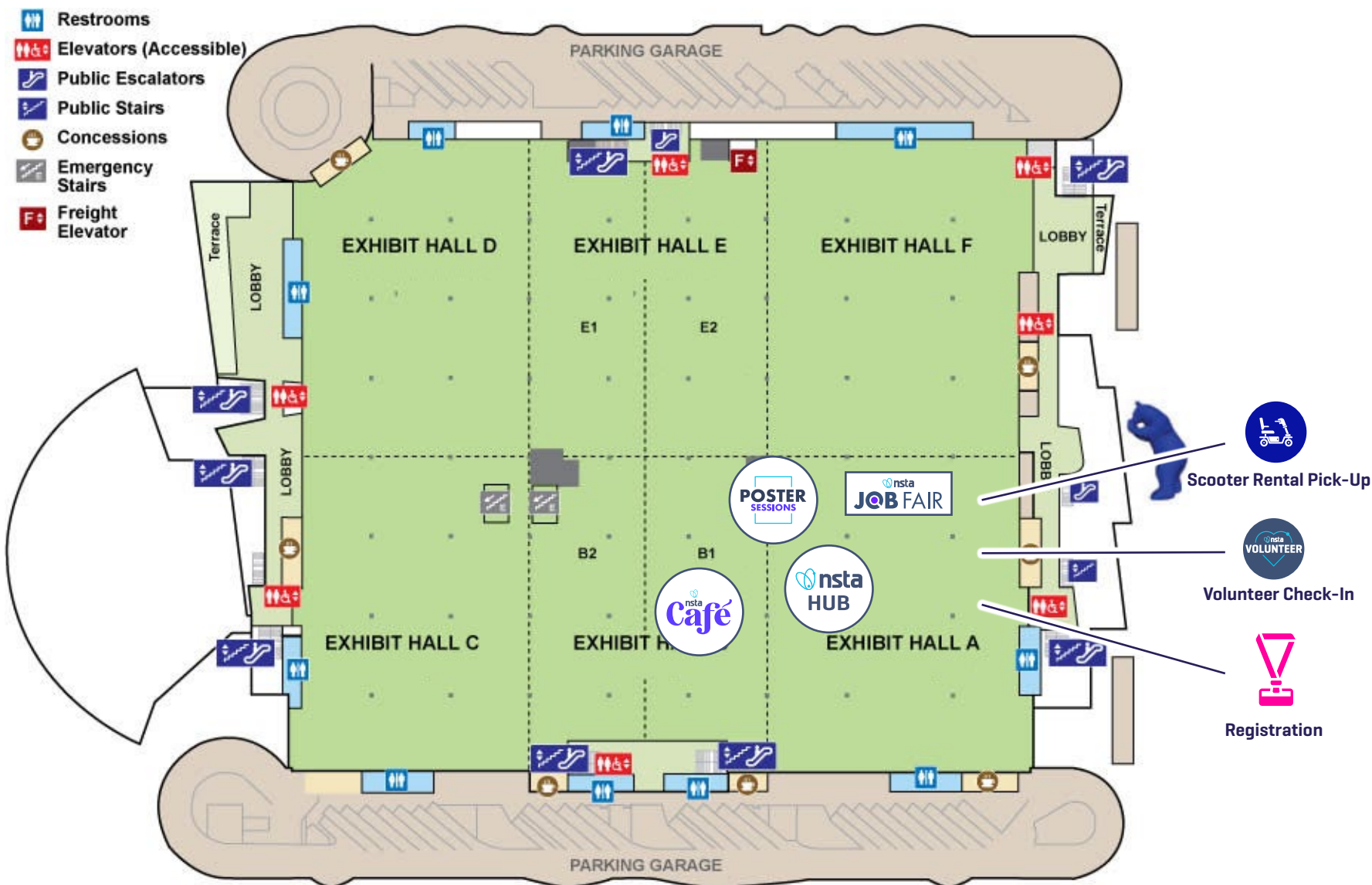

Level 3

[Click here to return to Points of Interest](#)

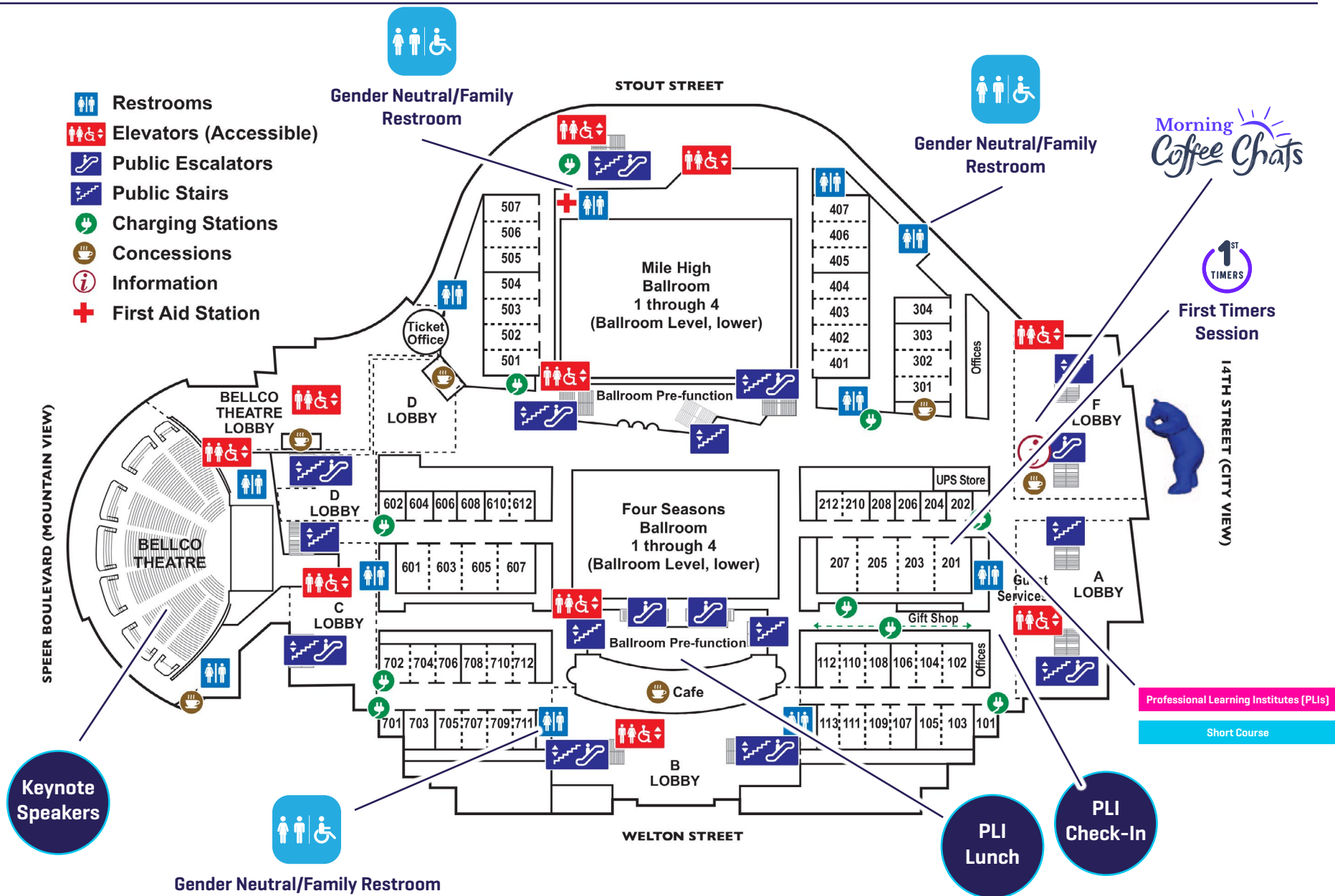

Lower Level

[Click here to return to Points of Interest](#)

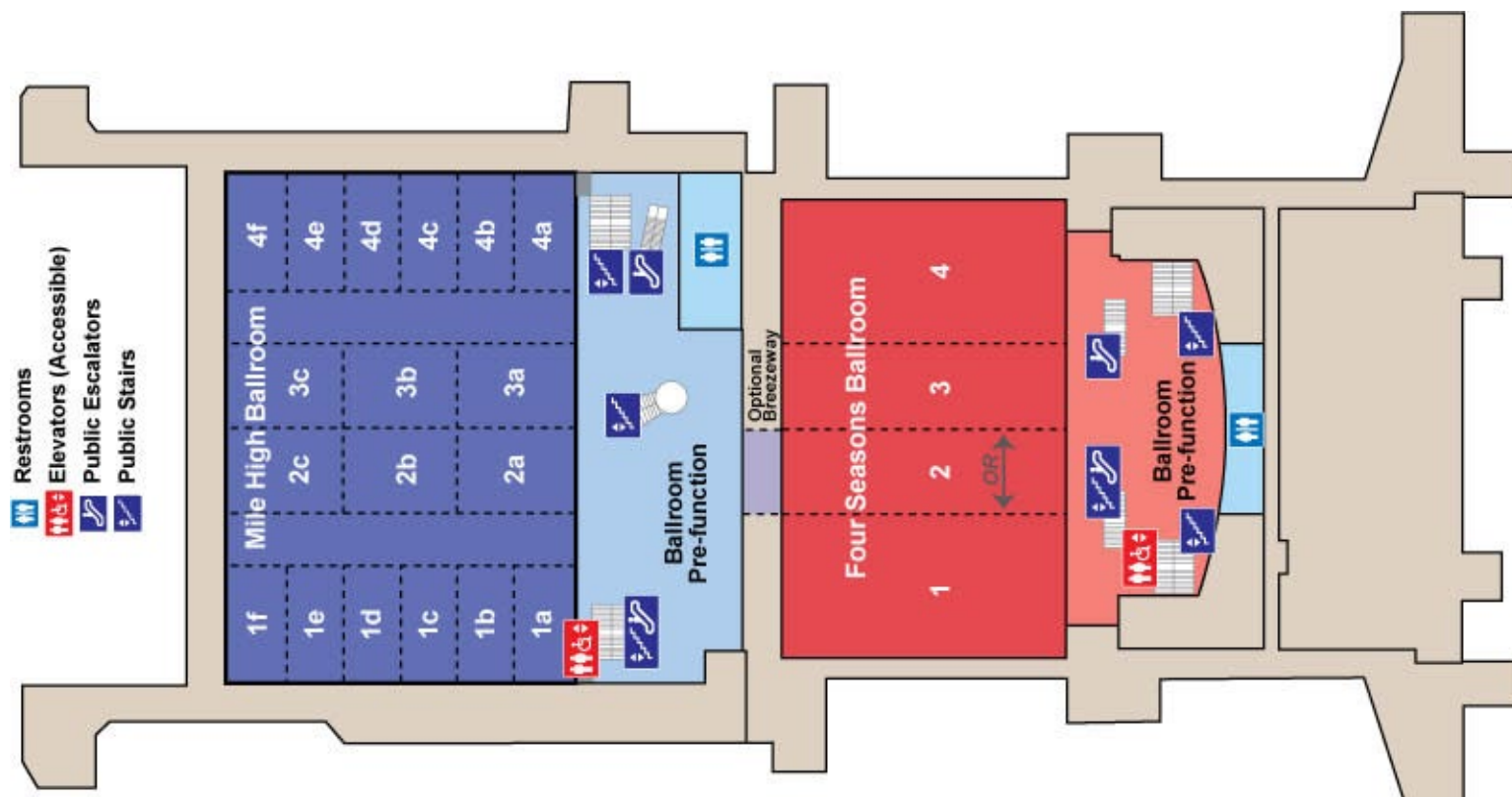



- | | | | | |
|---|---|--|--|---|
| 719 3D Molecular Designs | 438 Broad Institute of MIT and Harvard | 1010 Horizon Educational | 933 NOAA Office of Education | 628 STEM Sports [®] |
| 566 AALAS Foundation | 970 Butterfly Pavilion | 663 Imagine Learning | 867 Norman & Globus, Inc. | 233 STEMfinity, LLC |
| 202 Aauli School | 371 Calibre Scientific | 911 InnerOrbit | 974 NOVA Education | 303 STEMscopes by Accelerate Learning |
| 327 Accu-Scope | 503 Carolina Biological Supply Co. | 575 Intel SFI | 352 Nuclear Energy Education Initiative | 323 Step Info / Zolt Labs |
| 957 Acrome USA Inc | 464 CASFER NSF Engineering Research Center | 581 ISS National Laboratory | 409 Nutrients for Life Foundation | 463 Site Education |
| 426 Activate Learning | 1023 Celebrate Science | 639 Kendal Hunt Publishing Co. | 1022 Oak Ridge Institute for Science and Education | 448 Stokes Robotics |
| 831 Adventure Games North America | 502 Central Creativity | 457 Kiewit Project | 341 Ocean Diagnostics x Water Rangers | 443 Studies Weekly |
| 343 AFA STEM Programs | 224 Challenger Center | 311 Kibler Smith, LLC | 1003 Ohaus Corporation | 370 SynDaver |
| 205 Agile Education Marketing | 440 Clemson University | 733 Knowles Teacher Initiative and Marketing and Communications | 779 Omnica (Wildix Silx Co.) | 679 TCI |
| 538 AIAA | 522 Cognitive Surplus | 623 Kognity | 871 Optika America Froggabo Inc. | 562 TeachKind |
| 635 Alidms Biotechnology | 511 Colorado Association of Science Teachers | 739 Lab-Aids, Inc. | 472 Otto Trading, Inc. | 949 TERC |
| 962 Aldon Corporation | 977 Community Training and Assistance Center (CTAC) | 557 LadyLedLuxury | 315 PASCO | 813 Texas Instruments |
| 446 American Association for Cancer Research | 215 Cradle of Forestry Int. Assoc Forest Service | 923 LaMotte Co. | 922 Pearls With Purpose | 989 The American Ceramic Society |
| 410 American Association of Chemistry Teachers | 547 Crash Science in the Classroom presented by IHS | 907 Ledco | 731 PEER Physics | 955 The Aquaponic Source |
| 631 American College of Education | 780 Creative Discovery Museum | 228 Legends of Learning | 653 Petal Learning | 948 The National Academies of Science Gulf Research Program |
| 673 American Farm Bureau Foundation for Agriculture | 902 CrunchLabs w/ Mark Rober | 615 LEGO Education | 823 Pets in the Classroom | 362 The National Academies of Sciences, Engineering, and Medicine |
| 713 Amplify | 580 CSU Spur | 611 Louisiana Science Teachers Association | 433 Phenomenon Science Education | 347 The NEED Project |
| 519 Anatomage | 570 DAF Air & Space STEM Outreach | 938 Macmillan Publishers | 950 PHET Interactive Simulations | 956 TinkerCast |
| 735 ANATOMY IN CLAY [®] Learning System | 213 DataClassroom | 577 Marine Biological Laboratory | 520 Pilco Education | 529 TOPS Learning Systems |
| 470 Anatomy Warehouse | 473 Dean Vaughn | 471 Master of Science in Science Education (MSSE) | 1014 Pivot Interactives | 872 Toshiba/nSTA Exploravision |
| 565 Animal Welfare Institute | 355 Denver Museum of Nature & Science | 471 Montana State University | 963 Population Connection | 872 Touch of Life Technologies |
| 1024 Aquaponic Engineering and Design | 359 DigitalEd Education Solutions, Inc. | 335 Minerals Education Coalition | 921 Positive Physics & Chemistry | 373 Triebold Paleontology |
| 372 Aquaponics USA, LLC | 815 Display Information Center | 506 MiniOne Systems | 578 ProMeDKL | 927 U.S. Geological Survey |
| 847 Arbor Science | 210 EARTHDAY.ORG | 442 Mississippi State University | 905 Printed Solid | 1027 U.S. Patent and Trademark Office |
| 976 ARMI / BioFab | 374 EarthEcho International | 351 Modular Millwork, LLC | 863 Propello | 349 UCAR |
| 646 Army Educational Outreach Program | 946 EarthScope Consortium | 943 MolyMod Models - Spirring Enterprises Limited | 839 Publisher Spotlight | 833 UL Research Institutes |
| 331 ARRL Teachers Institute on Wireless Tech/Amateur Radio on the ISS | 953 E-Blox Inc | 909 Mosa Mack Science | 636 Quantum Resource Professionals | 376 United Scientific |
| 566 Bell Aerospace | 449 ECA Science K12 Services | 1021 Motic Swift Line | 972 Quantum Scholars | 573 US Extremely Large Telescope Program / NSF's NOIRLab |
| 367 Because Science | 624 Edvotek Inc. | 947 MyScale | 967 qwerty | 776 US Navy Recruiting |
| 971 Bedford, Freeman & Worth High School Publishers | 412 El Explora America | 211 Nanoscale Scientists Publishing LLC | 658 Rigamajig | 830 USA BMX Foundation |
| 218 Berko Productions DBA Clix Therapy (formerly WonderPax) | 346 EPA Office of Research and Development | 377 NASA Goddard Space Flight Center | 454 Sanford Underground Research Facility | 981 USA Science & Engineering Festival |
| 364 Beyond Labz | 533 ePlanetarium | 881 Nasco Education | 965 School Tours of America | 425 Visible Body |
| 572 Big Kid Science | 336 Esri | 778 National Bighorn Sheep Center | 636 Science Outside | 954 VLab Education |
| 1067 Big Picture Ranch | 421 ExploreLearning | 515 National Geographic Learning Cengage Learning | 518 Science Travel Adventures | 571 Ward's Science |
| 937 Bio Corporation | 877 Firefly Books | 1020 National Institute of Biomedical Imaging and Bioengineering, NIH | 339 Scientific Ocean Drilling | 1009 Wellness Consultants |
| 366 Biobrain Learning Pty Ltd | 437 Fisher Science Education | 354 National Institute of General Medical Sciences | 527 Shell Science Lab Challenge | 966 Wildlife Conservation Society |
| 563 BioLEAP | 219 Flinn Scientific, Inc. | 973 National Institute on Alcohol Abuse and Alcoholism (NIAAA) | 435 Simulation Curriculum | 1012 Wings Over the Rockies |
| 650 Bio-Rad Laboratories | 214 Forestry Suppliers Inc. | 220 National Institute on Deafness and Other Communication Disorders (NIDCD) | 959 Skulls Unlimited International Inc | 310 Wisconsin Fast Plants Program |
| 551 Biolity | 874 GARDYN | 880 National Inventors Hall of Fame | 555 Slooh | 730 WorldStrides |
| 726 BIOZONE Corp. | 878 GiantMicrobes | 772 National Nanotechnology Coordinated Infrastructure | 559 Smart Girls HQ | 903 Woz ED |
| 875 Botomgo LLC | 437 Girls Who Code | 734 National STEM Honor Society | 1025 Society for Neuroscience | |
| 312 BrainPOP | 781 Guardian Travel Group | 358 NNH/HR | 204 Sol Science Society of America | |
| 525 BrainStorm STEM Education | 532 hand2mind | | 222 SpatialGrow | |
| | 203 HHMI Biointeractive | | 725 Starlab | |

Levels 3

[Click here to return to Points of Interest](#)

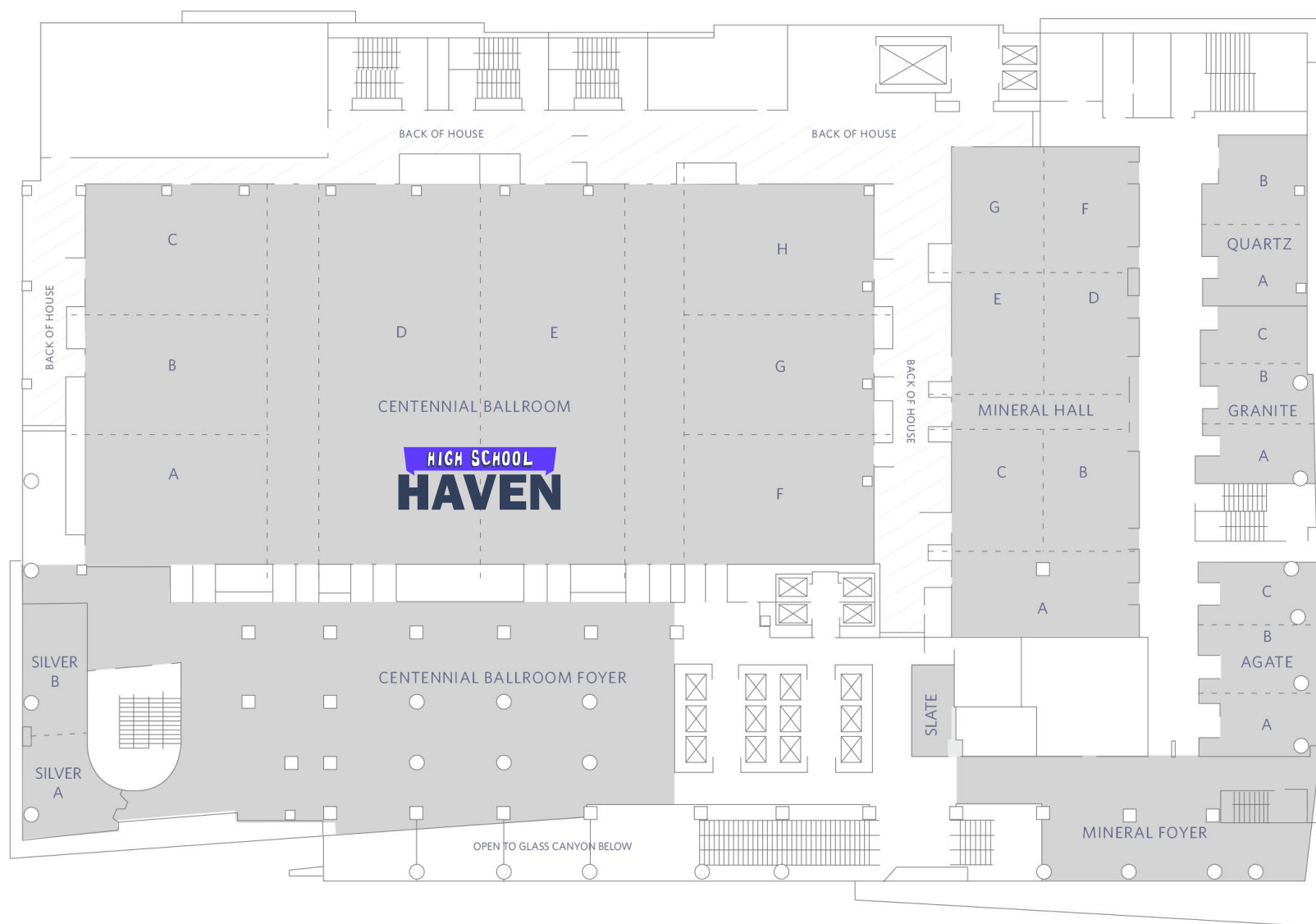

Levels 4

[Click here to return to Points of Interest](#)

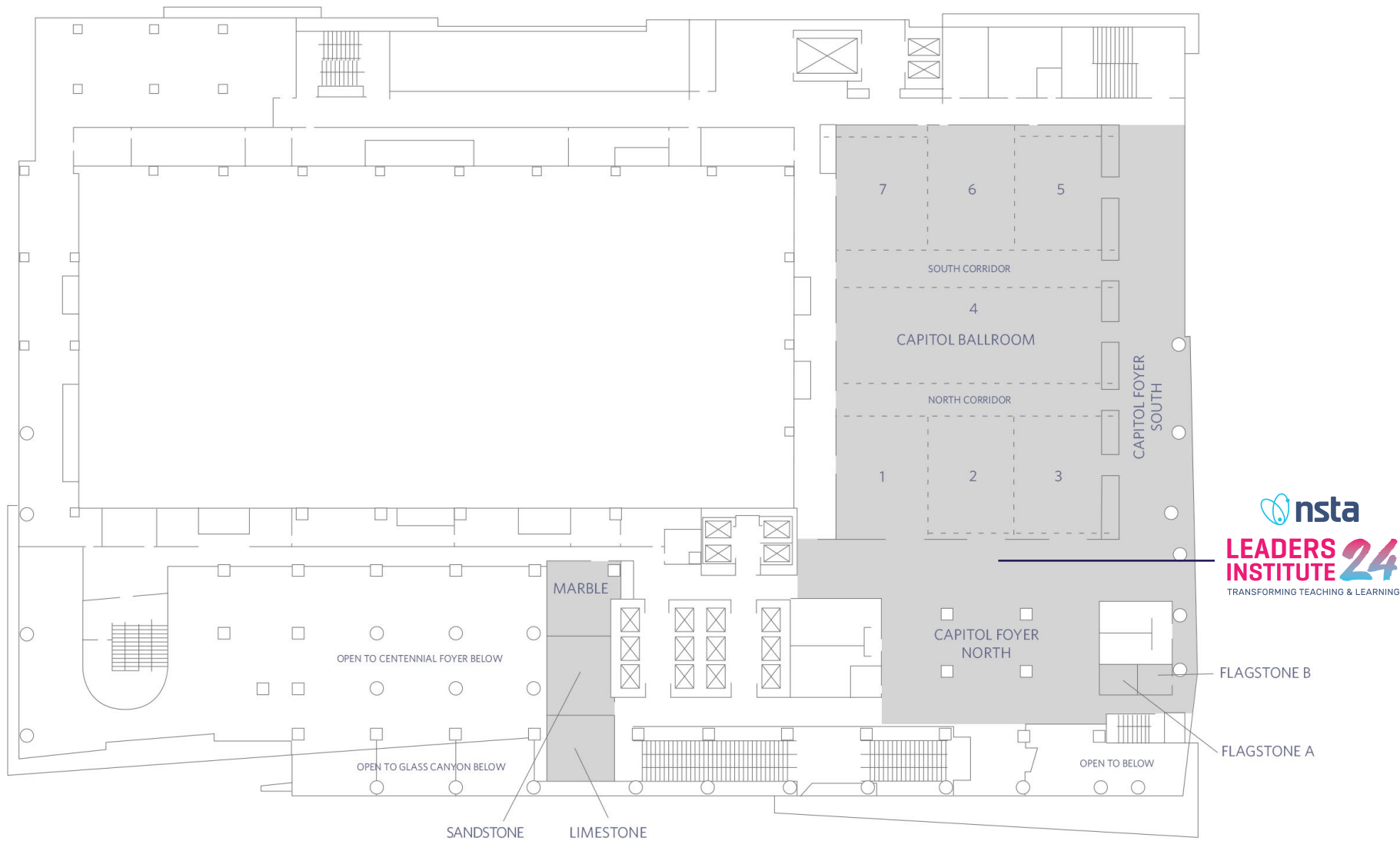

[Click here to return to Points of Interest](#)

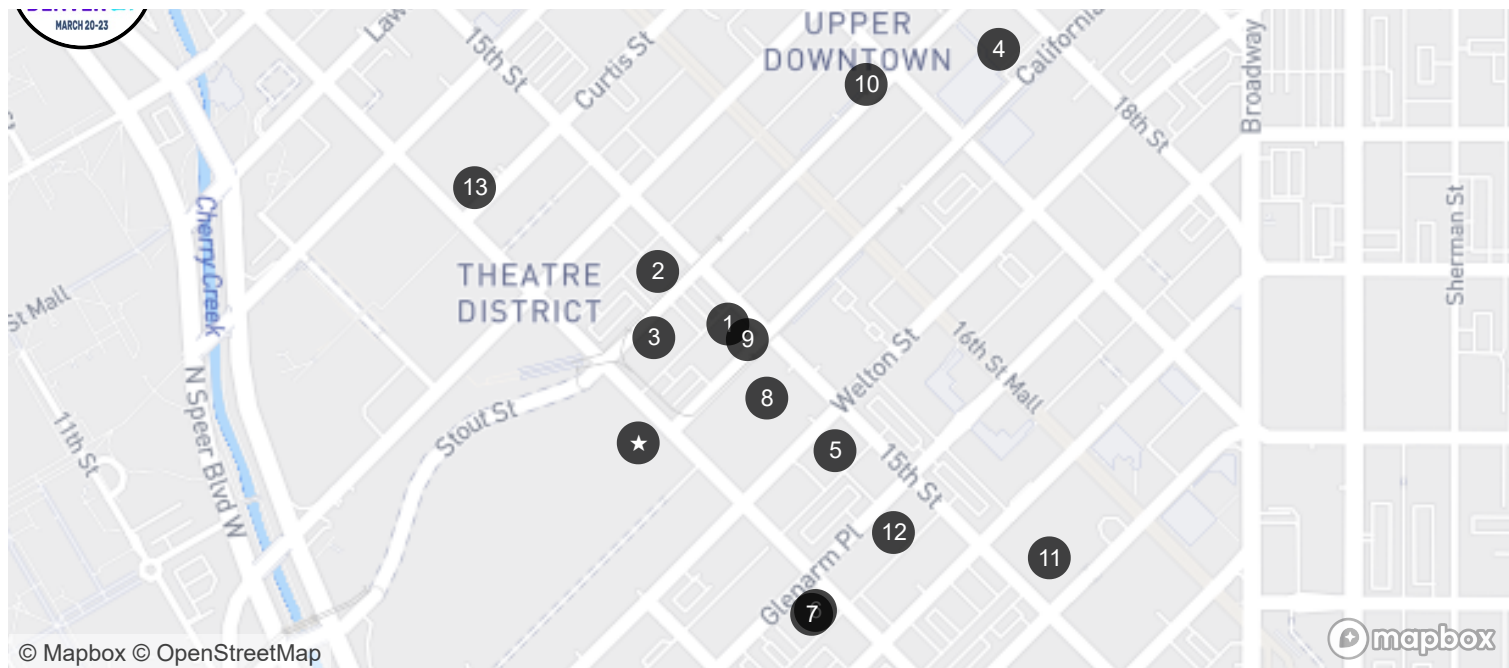

Colorado Convention Center
700 14th St.
Denver, CO 80202

3

**Embassy Suites by Hilton
Denver Downtown Convention
Center**
Lodging
1420 Stout St.
Denver, CO 80202
Distance to CCC - 0.1 Miles

6

HYATT House Denver Downtown
Lodging
440 14th St.
Denver, CO 80202
Distance to CCC - 0.2 Miles

9

Le Méridien Denver Downtown
Lodging
1475 California St.
Denver, CO 80202
Distance to CCC - 0.1 Miles

12

Sonesta Denver Downtown
Lodging
1450 Glenarm Pl.
Denver, CO 80202
Distance to CCC - 0.2 Miles

1

AC Hotel Denver
Things to Do
750 15th St.
Denver, CO 80202
Distance to CCC - 0.1 Miles

4

Hilton Denver City Center
Lodging
1701 California St.
Denver, CO 80202
Distance to CCC - 0.4 Miles

7

Hyatt Place Denver Downtown
Lodging
440 14th St.
Denver, CO 80202
Distance to CCC - 0.2 Miles

10

**Magnolia Hotel Denver, a Tribute
Portfolio Hotel**
Lodging
818 17th St.
Denver, CO 80202
Distance to CCC - 0.3 Miles

13

**The Curtis - a DoubleTree by
Hilton**
Lodging
1405 Curtis St
Denver, Colorado 80202
Distance to CCC - 0.2 Miles

2

Aloft Denver Downtown
Lodging
800 15th St.
Denver, CO 80202
Distance to CCC - 0.1 Miles

5

**Homewood Suites
Denver/Downtown - Convention
Center**
Lodging
550 15th St.
Denver, CO 80202
Distance to CCC - 0.2 Miles

8

**Hyatt Regency Denver at
Colorado Convention Center**
Lodging
650 15th St.
Denver, CO 80202
Distance to CCC - 0.1 Miles

11

**Sheraton Denver Downtown
Hotel**
Lodging
1550 Court Pl.
Denver, CO 80202
Distance to CCC - 0.4 Miles

Step inside these locations in 360° at
<https://share.threshold360.com/map/b32pqb>

