



FLOOR PLANS

Georgia World Congress Center
Centennial Olympic Park



How can we accommodate you?

Whether it's the right size **ROOM** to excite your sales force about a new innovation or the perfect area to generate an early buzz for your business, the space you choose plays an important part in your success.

The following floor plans give you all the nitty-gritty details you need to determine exactly how accommodating the Georgia World Congress Center can be.

Not only do we have the space to handle just about any function, you'll find it comes with unsurpassed flexibility and a staff of experts who will have the answers you require practically before you ask the questions.



Quick overview of our three buildings

- 3.9+ million square feet
- 12 exhibit halls with 1.4 million square feet of prime space
- 98 meeting rooms
- Executive Boardroom
- 2 ballrooms
- 3 fixed-seat auditoriums
- Corporate conference center
- Almost 7,000 parking spaces in decks and surface lots
- Fully ADA accessible
- Complete network connectivity, telecom solutions, and WIFI throughout
- 88 loading docks
- Exhibit halls with drive-on access
- 3 beautifully landscaped outdoor plazas ideal for afterhours functions



Building Legend

- First Aid Station
- Building Directory
- Women's Restroom
- Men's Restroom
- Escalator
- Food Service
- Elevator
- ATM

Linetype Legend

- Airwalls
- Low Ceilings

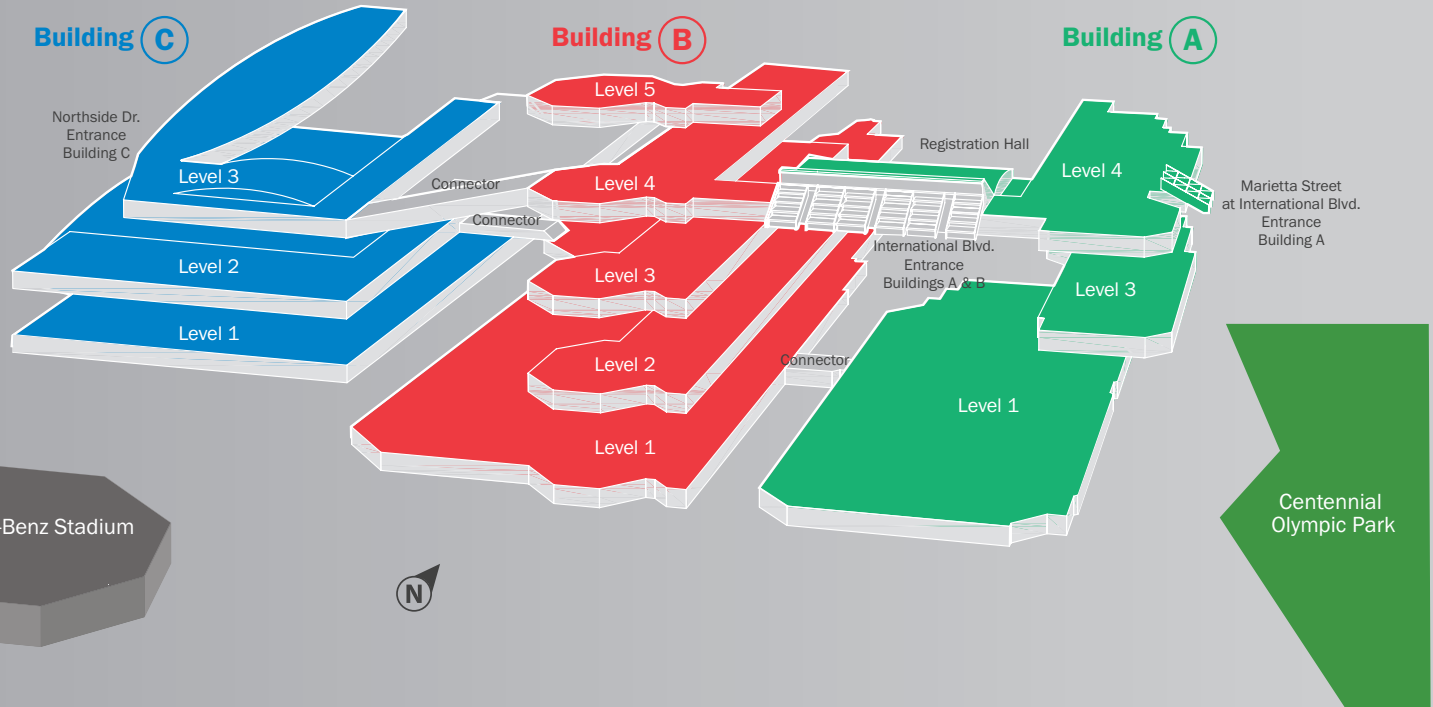

A1

149,000 Square Feet
 Ceiling Height 30' to the bottom of the grid
 Dropped Ceiling Height 16'
 Floor Boxes are on 30' Centers
 Columns are on 90' Centers
 Big Columns are 10.5' x 12'
 Lights in this hall can be turned off individually without lift required
 Floor Load 350 lbs. per square foot
 – Slab on Grade
 Docks 1–5

Overhead Doors

- A1e 22'w x 25'10"h
- A1g 18'w x 16'7"h
- A1i 28'10"w x 15'5"h

Entrance Access Doors

- A1a 18'w x 16'h

A2

86,000 Square Feet
 Ceiling Height 30' to the bottom of the grid
 Dropped Ceiling Height 16'
 Floor Boxes are on 30' Centers
 Columns are on 90' Centers
 Lights in this hall can be turned off individually without lift required
 Floor Load 350 lbs. per square foot
 – Slab on Grade
 Docks 6–10

Overhead Doors

- A2b 28'9"w x 15'4"h
- Entrance Access Doors
- A2a 18'w x 16'h
- A2c 18'w x 16'h

A3

105,000 Square Feet
 Ceiling Height 30' to the bottom of the grid
 Dropped Ceiling Height 16'
 Floor Boxes are on 30' Centers
 Columns are on 90' Centers and 180' Centers
 Lights in this hall can be turned off individually without lift required
 Floor Load 350 lbs. per square foot
 – Slab on Grade
 Docks 11–15

Overhead Doors

- A3b 22'8"w x 16'2"h
- A3d 22'10"w x 25'10"h
- A3e 14'5"w x 15'10"h

Entrance Access Doors

- A3a 18'w x 16'h

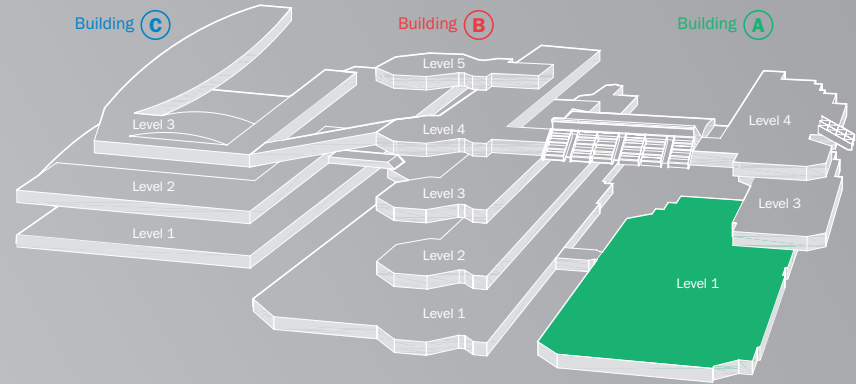

Exhibit Halls						
Room or Area	Theater Capacity	10x10 Booths Capacity	Banquet Capacity	Useable Area		Ceiling Height
				Sq. Ft.	Sq. Meters	
Exhibit Hall A1	15,113	800	8,940	149,000	13,848	30'
Exhibit Hall A2	10,244	490	5,620	86,000	7,992	30'
Exhibit Hall A3	9,570	574	5,340	105,000	9,758	30'
Meeting Rooms*						
Room or Area	Theater Capacity	Classroom Capacity	Banquet Capacity	Useable Area		Ceiling Height
				Sq. Ft.	Sq. Meters	
A101	1,090	635	630	7,667	713	30'
A102	1,090	635	630	7,667	713	30'
A103	1,090	635	630	7,667	713	30'
A101-A103	3,096	1,504	1,920	23,079	2,146	30'

Note: *Only available if halls A1 and A2 are not divided.

Building A

- Information Desk
- East Plaza
- 3 Exhibit Halls
- 29 meeting rooms
- Sidney Marcus Auditorium
- Executive Boardroom



Building A — Level One Exhibit Halls

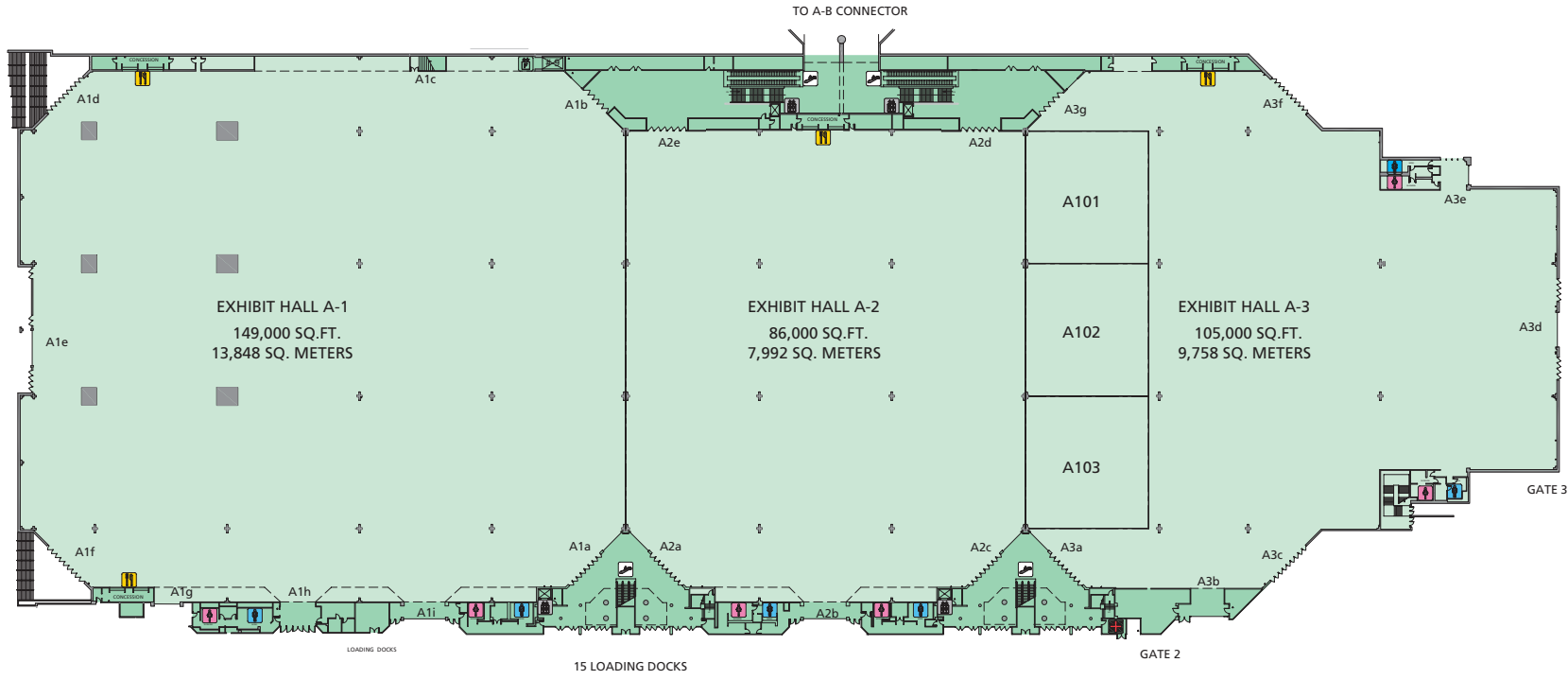

Please note: Lighter shades on the detailed floor plans denote rentable space. Dotted lines indicate soffits (lowered ceilings).

Room or Area	Theater Capacity	Classroom Capacity	Banquet Capacity	Useable Area		Ceiling Height
				Sq. Ft.	Sq. Meters	
A301	331	153	170	2,863	266.3	15'2"
A302	516	250	270	4,239	394.2	16'1"
A303	112	62	80	1,311	121.9	12'1"
A304	112	62	80	1,311	121.9	12'1"
A305	536	250	270	4,272	397.3	16'1"
A306	49	28	20	534	49.6	11'9"
A307	206	98	110	1,897	176.4	9'1"
A308a	49	24	20	454	42.2	8'6"
A308b	31	18	20	486	45.2	8'6"
A309	206	98	110	1,897	176.4	9'1"
A310	98	40	40	950	88.4	11'
A311	264	120	150	2,647	246.2	16'
A312	252	114	150	2,625	244.1	16'
A311/A312	594	294	350	5,282	491.12	16'
A313	228	114	150	2,386	221.9	16'
A314	252	114	150	2,561	238.2	16'
A313/A314	570	294	340	4,958	461.1	16'
A315	170	84	100	1,812	168.5	14'
A316	166	84	100	1,816	168.9	14'
A315-A316	428	202	240	3,643	338.8	14'



Notes

.....

.....

.....

.....

Building A

Information Desk

East Plaza

3 Exhibit Halls

29 meeting rooms

Sidney Marcus Auditorium

Executive Boardroom

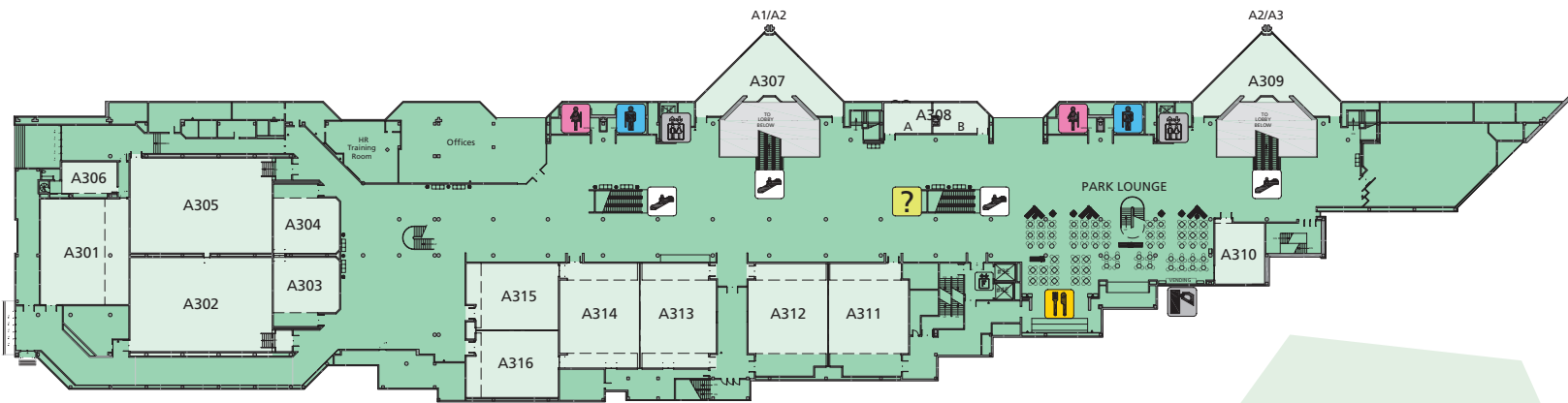
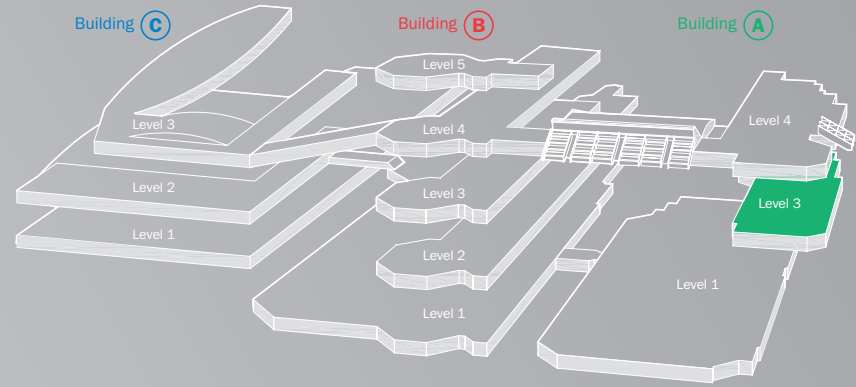

Building A — Level Three Concourse

Room or Area	Theater Capacity	Classroom Capacity	Banquet Capacity	Useable Area		Ceiling Height
				Sq. Ft.	Sq. Meters	
Sidney Marcus Auditorium						
Sidney Marcus Auditorium Building A	1,726 seats + 18 wheelchair spaces	N/A	N/A	15,689	N/A	28' to 50'
Executive Boardroom						
Executive Boardroom	N/A	34	34	2,593	N/A	N/A
Meeting Rooms						
A401	106	51	60	1,220	113.3	16'2"
A402	172	101	90	1,898	176.5	16'2"
A403	172	101	90	1,901	176.8	16'2"
A402/A403	406	218	240	3,779	351.4	16'2"
A404	210	115	90	2,058	191.4	14'9"
A405	210	115	90	2,048	190.5	14'9"
A404/A405	490	244	280	4,096	380.9	14'9"
A406	109	47	40	1,143	106.3	16'
A407	124	76	60	1,411	131.2	16'
A406/A407	276	153	170	2,553	237.4	16'
A408	136	80	60	1,492	143.5	14'10"
A409	69	34	30	785	72.46	13'7"
A410	381	189	180	3,331	309.8	16'
A411	716	345	400	5,834	542.6	17'3"
A411/A412b	1,066	534	570	8,153	758.2	17'3"
A412a	335	188	190	3,169	294.7	17'3"
A412	685	318	340	5,488	510.4	17'3"
A411/A412	1,527	747	780	11,291	1,050.1	17'3"

NOTE: Only one dividing wall is available in meeting rooms A411-412.



Building **A**

- Information Desk
- East Plaza
- 3 Exhibit Halls
- 29 meeting rooms
- Sidney Marcus Auditorium
- Executive Boardroom

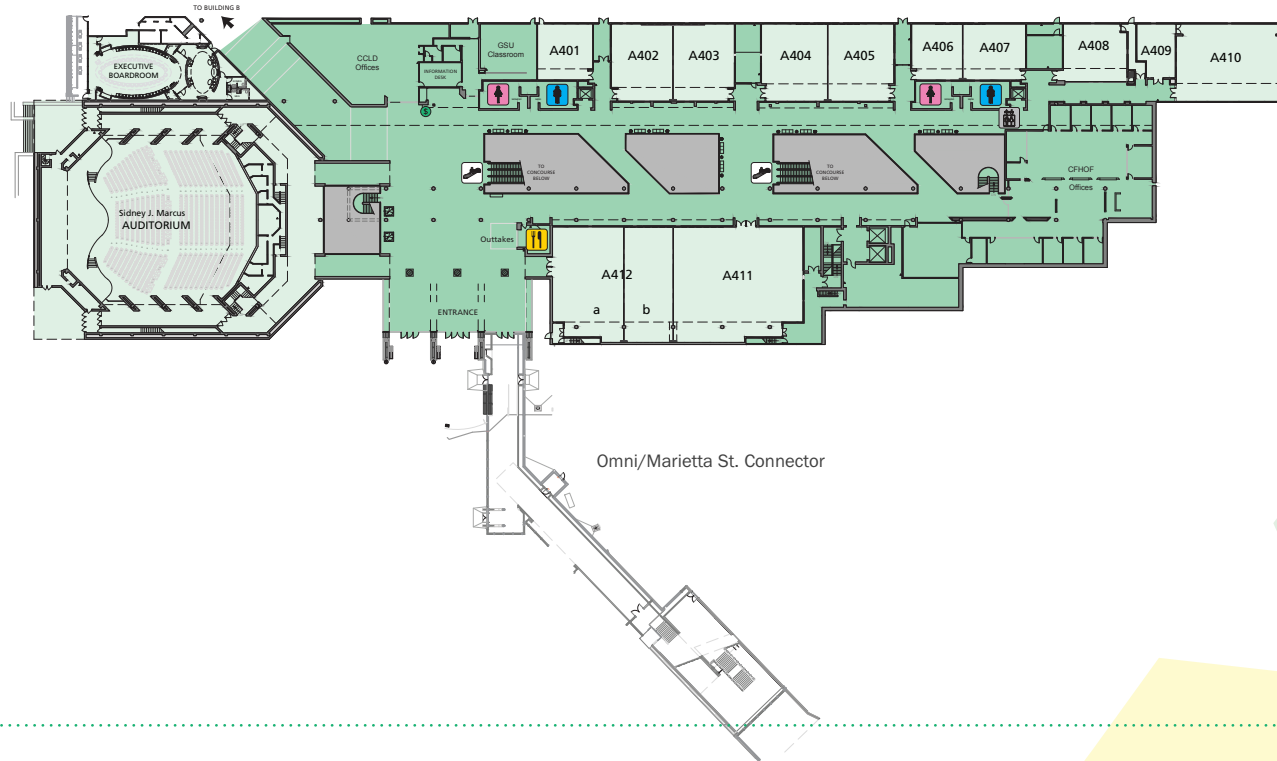
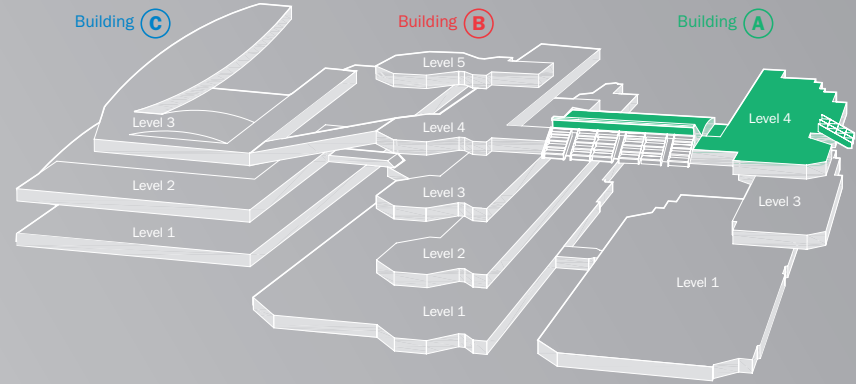

Building **A** — Level Four Concourse

Notes

B1

89,500 Square Feet
 Ceiling Height 30' to the bottom of the grid
 Dropped Ceiling Height 16'
 Floor Boxes are on 30' Centers
 Columns are on 90' Centers and 180' Centers
 Lights in this hall can be turned off individually without lift required
 Floor Load 350 lbs. per square foot — Slab on Grade
 Docks 53–57

Overhead Doors

B1b 20'w x 16'h
 B1c 24'w x 16'2"h
 B1e 24w x 15'h

Entrance Access Doors

B1a 19'3"w x 9'11"h

B4

149,500 Square Feet
 Ceiling Height 30' to the bottom of the grid
 Dropped Ceiling Height 16'
 Floor Boxes are on 30' Centers
 Columns are on 90' Centers and 180' Centers
 Lights in this hall can be turned off individually without lift required
 Floor Load 350 lbs. per square foot — Slab on Grade
 Docks 25–34

Overhead Doors

B4c 14'w x 16'h
 B4e 19'9"w x 15'7"h
 B4f 24'w x 15'7"h
 B4g 24'w x 15'7"h

Entrance Access Doors

B4a 19'10"w x 9'11"h
 B4d 19'10"w x 9'11"h

B2

96,000 Square Feet
 Ceiling Height 30' to the bottom of the grid
 Dropped Ceiling Height 16'
 Floor Boxes are on 30' Centers
 Columns are on 90' Centers
 Lights in this hall can be turned off individually without lift required
 Floor Load 350 lbs. per square foot — Slab on Grade
 Docks 45–52

Overhead Doors

B2e 19'11"w x 16'h
 B2f 24'w x 16'h
 B2g 20'w x 16'h

Entrance Access Doors

B2a 19'3"w x 9'11"h
 B2d 19'3"w x 9'11"h

B5

151,000 Square Feet
 Ceiling Height 30' to the bottom of the grid
 Dropped Ceiling Height 16'
 Floor Boxes are on 30' Centers
 Columns are on 90' Centers and 180' Centers
 Lights in this hall can be turned off individually without lift required
 Floor Load 350 lbs. per square foot — Slab on Grade
 Docks 16–24

B3

121,500 Square Feet
 Ceiling Height 30' to the bottom of the grid
 Dropped Ceiling High 16'
 Floor Boxes are on 30' Centers
 Columns are on 90' Centers
 Lights in this hall can be turned off individually without lift required
 Floor Load 350 lbs. per square foot — Slab on Grade
 Docks 35–44

Overhead Doors

B3b 20'w x 10'9"h
 B3d 18'w x 27'h
 B3e 23'w x 16'h
 B3f 19'10"w x 16'h

Entrance Access Doors

B3a 19'3"w x 9'11"
 B3c 19'10"w x 9'11"h

Overhead Doors

B5b 14'w x 16'h
 B5c 22'w x 15'7"h
 B5g 21'3"w x 15'7"h
 B5h 24'w x 15'7"h
 B5i 24'w x 15'7"h
 B5j 19'9"w x 15'7"h

Entrance Access Doors

B5a 19'10"w x 9'11"h

Building B

- Information Desk
- International Plaza
- 5 Exhibit Halls
- 47 meeting rooms
- Thomas Murphy Ballroom

- Amenities:**
- FedEx Office
 - Gift Shop
 - Southern Roots Cafe
 - Social Table

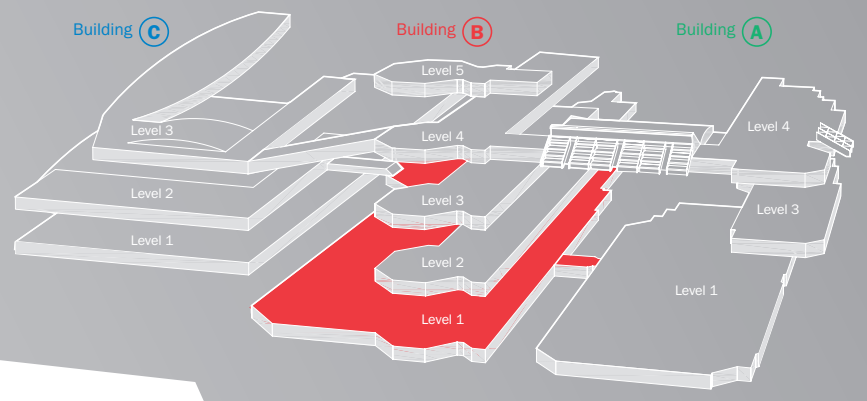

NOTE: Floor plan shown smaller scale.

Room or Area	Theater Capacity	10x10 Booths Capacity	Banquet Capacity	Useable Area		Ceiling Height
				Sq. Ft.	Sq. Meters	
Exhibit Halls						
Exhibit Hall B1	8,606	468	4,760	89,500	8,318	30'
Exhibit Hall B2	9,908	514	5,480	96,000	8,922	30'
Exhibit Hall B3	13,254	681	7,980	121,500	11,292	30'
Exhibit Hall B4	15,870	805	9,310	149,500	13,894	30'
Exhibit Hall B5	15,984	837	9,370	151,000	14,033	30'
Meeting Rooms						
Room or Area	Theater	Classroom	Banquet	Sq. Ft.	Sq. Meters	Ceiling
B101	1,050	555	550	6,435	598.4	30'
B102	1,090	635	630	7,513	698.7	30'
B103	1,050	555	550	6,435	598.4	30'
B101-B103	2,808	1,376	1,760	20,425	1,899.5	30'

Building B — Level One Exhibit Halls

Room or Area	Theater Capacity	Classroom Capacity	Banquet Capacity	Useable Area		Ceiling Height
				Sq. Ft.	Sq. Meters	
B201	202	92	100	1,857	172.7	14'6"
B202	198	109	110	2,113	196.5	14'6"
B203	390	200	220	3,645	338.9	15'2"
B204	198	109	110	2,109	196.1	14'6"
B205	48	21	20	471	43.8	8'6"
B206	740	376	420	6,638	617.3	15'2"
B207	291	146	160	2,799	260.3	14'6"
B208	291	146	160	2,803	260.7	14'6"
B207/B208	644	326	340	5,292	492.2	14'6"
B209	164	75	80	1,572	146.2	13'10"
B210	164	75	80	1,564	145.5	13'10"
B211	293	146	160	2,803	260.7	14'6"
B212	293	146	160	2,803	260.7	14'6"
B211/B212	644	326	340	5,292	492.5	14'6"
B213	270	123	160	2,617	243.4	14'6"
B214	270	123	160	2,616	243.3	14'6"
B213/B214	582	262	350	5,184	482.1	14'6"
B215	233	117	110	2,070	192.5	13'10"
B216	270	123	160	2,607	242.5	14'6"
B217	270	123	160	2,607	242.5	14'6"
B216/B217	582	262	350	5,169	480.7	14'6"
B218	234	117	110	2,075	193.0	13'10"



Building **B**

- Information Desk
- International Plaza
- 5 Exhibit Halls
- 47 meeting rooms
- Thomas Murphy Ballroom

- Amenities:**
- FedEx Office
 - Gift Shop
 - Southern Roots Cafe
 - Social Table

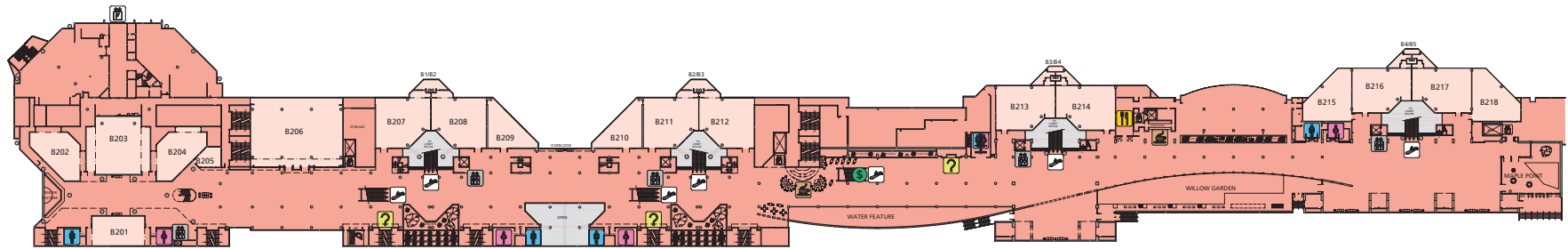
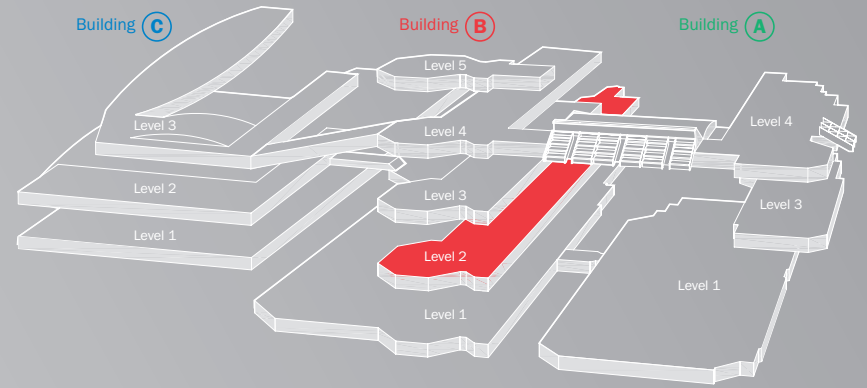

NOTE: Floor plan shown smaller scale.

Notes

.....

.....

.....

.....

Room or Area	Theater Capacity	Classroom Capacity	Banquet Capacity	Useable Area		Ceiling Height
				Sq. Ft.	Sq. Meters	
B301	198	109	110	2,120	197.2	14'6"
B302	286	128	150	2,773	257.9	20'
B303	314	136	170	3,115	289.7	20'
B304	314	136	170	3,115	289.7	20'
B305	286	128	150	2,733	257.9	20'
B302/B303	611	323	310	5,900	548.7	20'
B302-B304	1,036	520	550	9,028	839.6	20'
B303/B304	652	324	360	6,243	580.6	20'
B302-B305	1,340	684	680	11,795	1,096.9	20'
B304/B305	611	323	310	5,900	548.7	20'
B306	198	109	110	2,120	197.2	14'6"
B307	50	21	20	471	43.8	8'6"
B308	332	164	180	3,111	289.3	15'10"
B309	332	164	180	3,105	288.3	15'10"
B308/B309	740	376	420	6,171	573.9	15'10"
B310	212	108	130	2,178	202.5	14'6"
B311	212	108	130	2,178	202.5	14'6"
B312	408	210	220	3,476	323.3	15'10"
B313a	218	107	110	1,996	185.6	15'10"
B313b	218	107	110	1,994	185.4	15'10"
B313	470	232	250	4,002	372.2	15'10"
B314	422	210	230	3,514	326.8	15'10"
B312/B313a	691	337	390	5,484	510.0	15'10"
B312/B313	946	482	560	7,490	696.6	15'10"
B313b/B314	691	482	390	5,484	513.3	15'10"
B313/B314	946	482	560	7,490	700.1	20'
B312-B314*	1,368	710	780	11,016	1,024.5	15'10"
*NOTE: Only two dividing walls are available in meeting rooms B312-B314.						
B315	212	108	130	2,178	202.5	14'6"
B316	212	108	130	2,178	202.5	14'6"
B317	49	24	20	462	43.0	8'6"
B318	49	24	20	458	42.6	8'6"
B319	49	24	20	479	44.5	8'6"



Building **B**

- Information Desk
- International Plaza
- 5 Exhibit Halls
- 47 meeting rooms
- Thomas Murphy Ballroom

- Amenities:**
- FedEx Office
 - Gift Shop
 - Southern Roots Cafe
 - Social Table

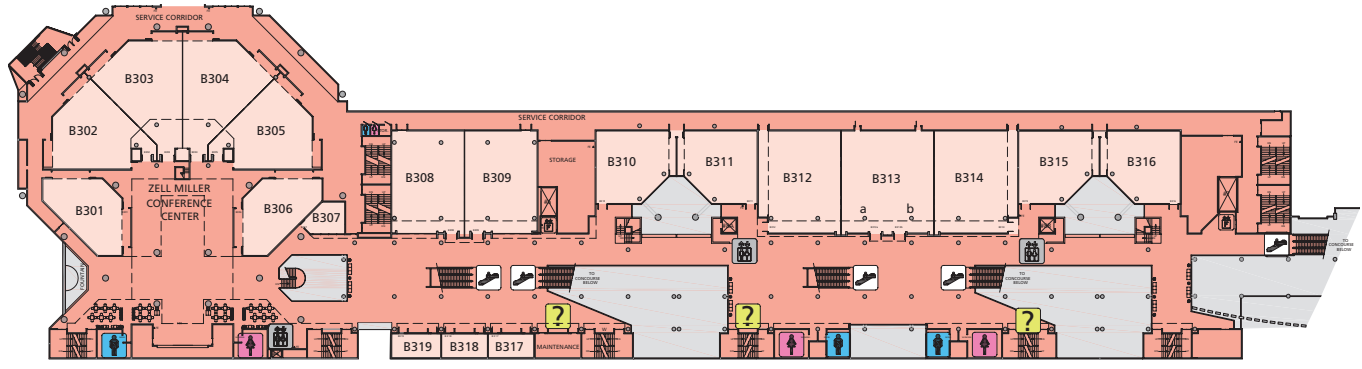
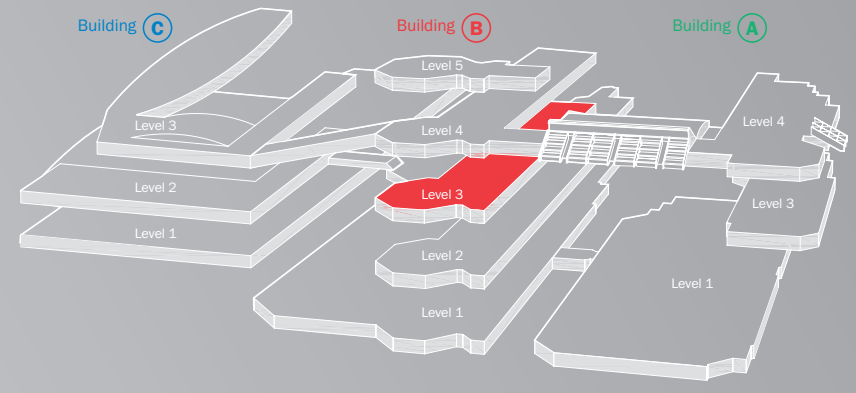

NOTE: Only two dividing walls are available in meeting rooms B312-B314.

Notes

Room or Area	Theater Capacity	Classroom Capacity	Banquet Capacity	Useable Area		Ceiling Height
				Sq. Ft.	Sq. Meters	
B401	332	164	180	3,111	289.3	15'10"
B402	332	164	180	3,105	288.8	15'10"
B401/B402	740	376	420	6,171	573.9	15'10"
B403	212	108	130	2,182	202.9	14'6"
B404	212	108	130	2,182	202.9	14'6"
B405	408	210	220	3,476	323.3	15'10"
B406a	218	107	110	1,996	185.6	15'10"
B406b	218	107	110	1,994	185.4	15'10"
B406	470	232	250	4,002	372.2	15'10"
B407	422	210	230	3,514	326.8	15'10"
B405/B406a	691	337	390	5,484	510	15'10"
B405/B406	946	480	560	7,490	696.6	15'10"
B406b/B407	691	482	390	5,484	513.3	15'10"
B406/B407	946	480	560	7,490	696.6	15'10"
B405-B407*	1,368	710	780	11,016	1,024.5	15'10"
*NOTE: Only two dividing walls are available in meeting rooms B405-B407.						
B408	212	108	130	2,178	202.5	14'6"
B409	212	108	130	2,178	202.5	14'6"
B411	28	12	20	465	42.7	8'6"



Notes

.....

.....

.....

Building B

- Information Desk
- International Plaza
- 5 Exhibit Halls
- 47 meeting rooms
- Thomas Murphy Ballroom

- Amenities:**
- FedEx Office
 - Gift Shop
 - Southern Roots Cafe
 - Social Table

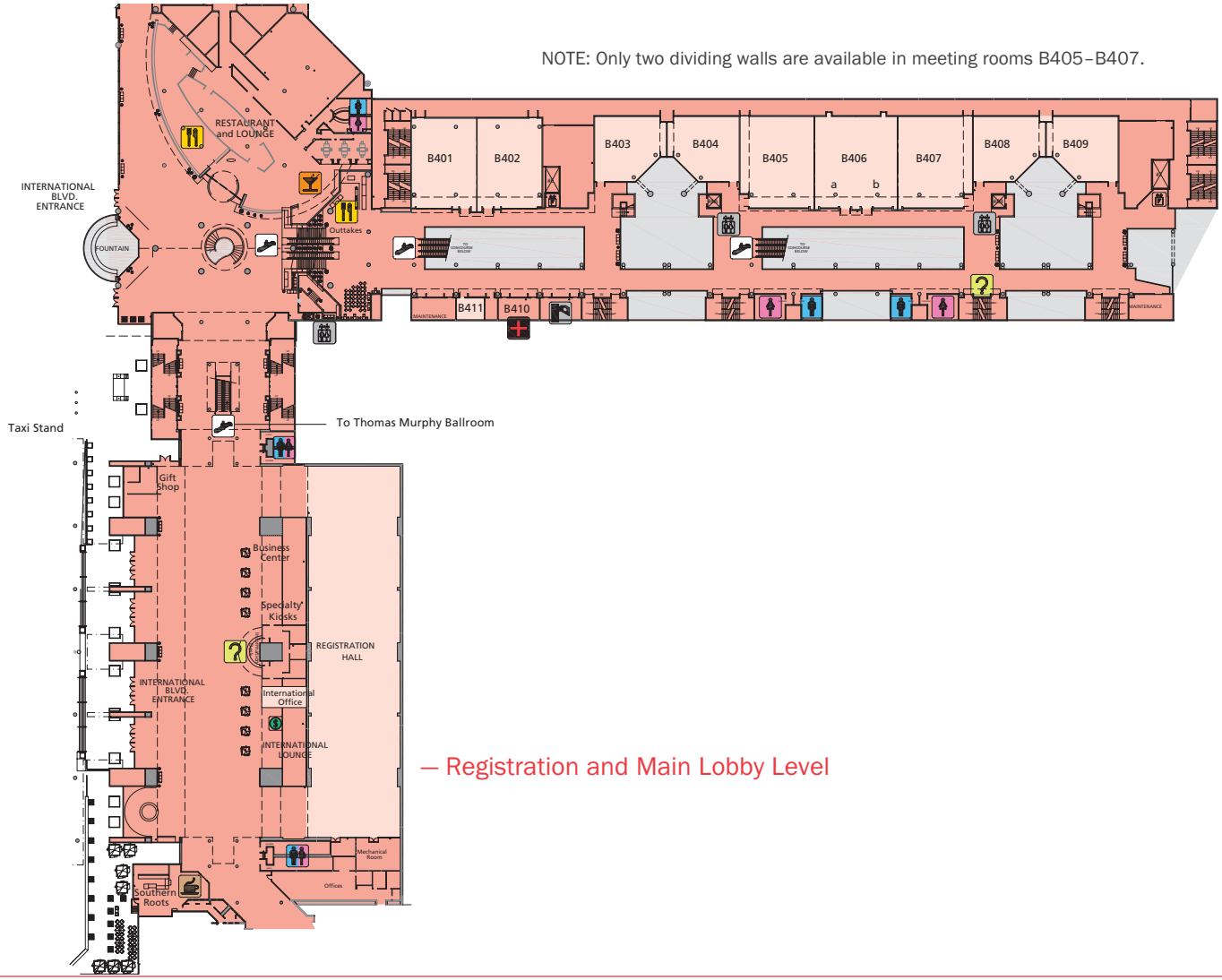
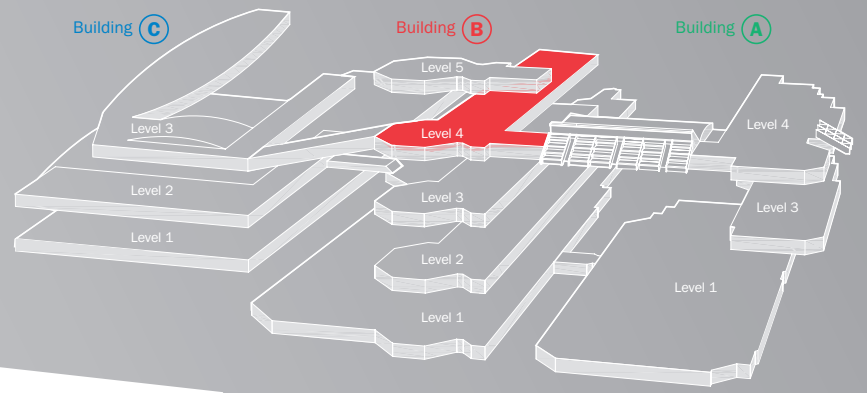

— Registration and Main Lobby Level

Room or Area	Theater Capacity	Classroom Capacity	Banquet Capacity	Useable Area		Ceiling Height
				Sq. Ft.	Sq. Meters	
Thomas Murphy Ballroom Building B – Sections 1-4	4,500	1,854	2,560	33,000	3,069	27' - 37'
Thomas Murphy Ballroom Building B – Sections 1-3 or 2-4	3,414	1,478	1,880	24,740	2,300	27' - 37'
Thomas Murphy Ballroom Building B – Sections 1-2 or 3-4*	2,030	997	1,100	16,000	1,534	27' - 37'
Thomas Murphy Ballroom Building B – Sections 2-3*	2,500	997	1,350	16,500	1,534	27' - 37'
Thomas Murphy Ballroom Building B – Section 1 or 4*	800	356	430	8,260	768	27' - 37'
Stage	N/A	N/A	N/A	2,000	N/A	N/A
Galleria	N/A	N/A	N/A	18,000	N/A	N/A

*NOTE: Only enough panels are available to complete two dividing walls at any given time in the Thomas Murphy Ballroom.



Building **B**

- Information Desk
- International Plaza
- 5 Exhibit Halls
- 47 meeting rooms
- Thomas Murphy Ballroom

- Amenities:**
- FedEx Office
 - Gift Shop
 - Southern Roots Cafe
 - Social Table

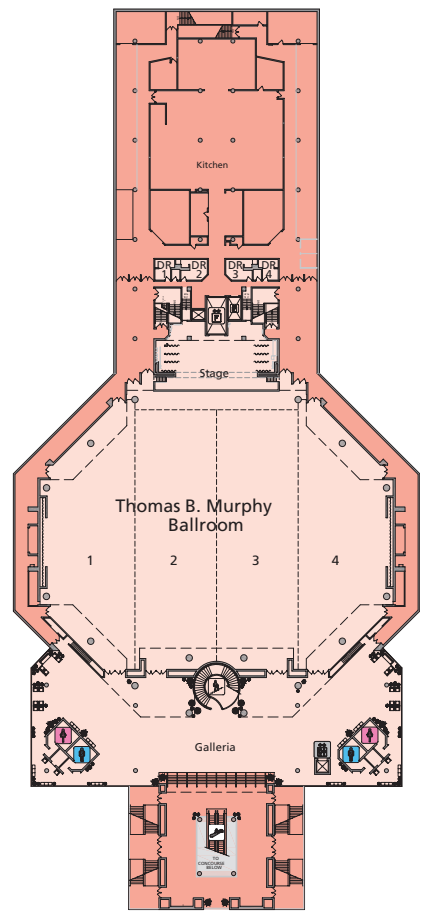
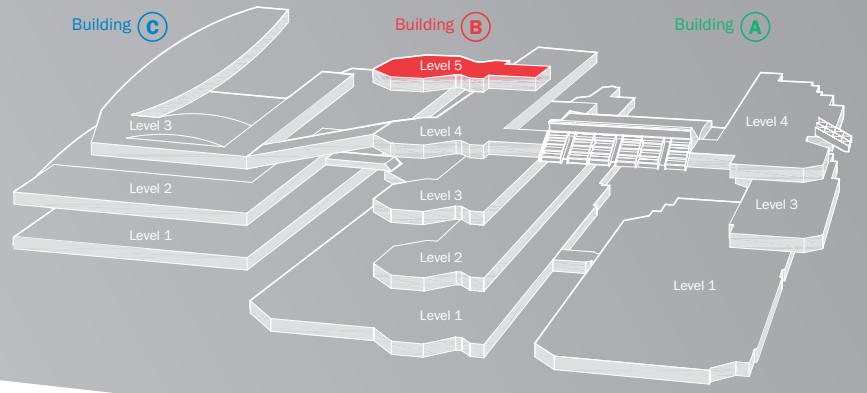

NOTE: Only enough panels are available to complete two dividing walls at any given time in the Thomas Murphy Ballroom.

Building **B** — Level Five Ballroom

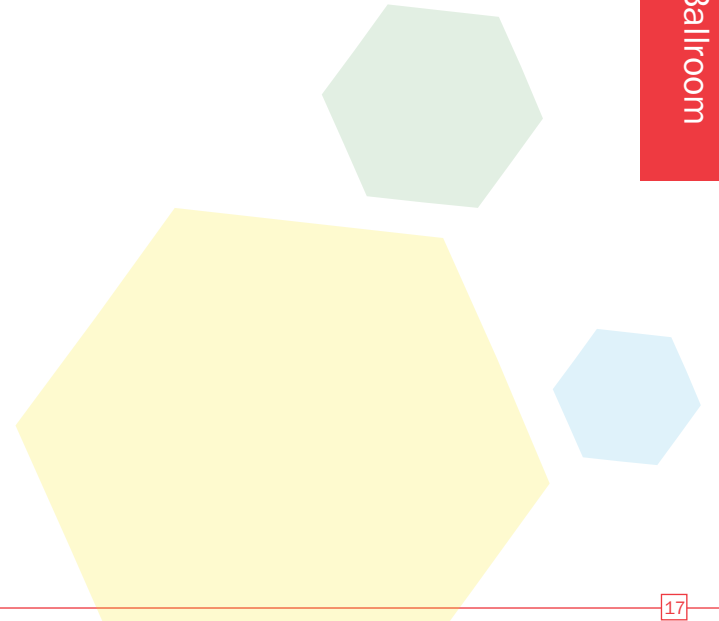



C1

103,250 Square Feet

Ceiling Height 30' to the bottom of the grid
 Dropped Ceiling Height 16'
 Floor Boxes are on 30' Centers
 Columns are on 90' Centers
 Lights in this hall can be turned off individually without lift required
 Floor Load 400 lbs. per square foot — Slab on Grade
 Docks 58-64

Overhead Doors

C1f 19'3"w x 16'h

Entrance Access Doors

C1a 12'9"w x 21'6"h

C1b 12'9"w x 21'6"h

C1d 12'9"w x 21'6"h

C2

106,000 Square Feet

Ceiling Height 30' to the bottom of the grid
 Dropped Ceiling Height 16'
 Floor Boxes are on 30' Centers
 Columns are on 90' Centers
 Lights in this hall can be turned off individually without lift required
 Floor Load 400 lbs. per square foot — Slab on Grade
 Docks 65-72

Overhead Doors

C2b 19'3"w x 16'h

Entrance Access Doors

C2a 12'9"w x 21'6"h

C2e 12'9"w x 21'6"

C3

106,000 Square Feet

Ceiling Height 30' to the bottom of the grid
 Dropped Ceiling Height 16'
 Floor Boxes are on 30' Centers
 Columns are on 90' Centers
 Lights in this hall can be turned off individually without lift required
 Floor Load 400 lbs. per square foot — Slab on Grade
 Docks 73-80

Overhead Doors

C3c 20'w x 16'h

C3d 19'3"w x 16'h

Entrance Access Doors

Doors

C3a 12'9"w x 21'6"h

C3e 12'9"w x 21'6"h

C4

100,000 Square Feet

Ceiling Height 30' to the bottom of the grid
 Dropped Ceiling High 16'
 Floor Boxes are on 30' Centers
 Columns are on 90' Centers
 Lights in this hall can be turned off individually without lift required
 Floor Load 400 lbs. per square foot — Slab on Grade
 Docks 81-88

Overhead Doors

C4b 19'3"w x 16'h

C4c 20'w x 16'h

C4d 24'w x 27'h

Entrance Access Doors

C4a 12'9"w x 21'6"h

Room or Area	Theater Capacity	10x10 Booths Capacity	Banquet Capacity	Useable Area		Ceiling Height
				Sq. Ft.	Sq. Meters	
Exhibit Halls						
Exhibit Hall C1	9,264	538	6,100	103,250	77,110	30'
Exhibit Hall C2	9,264	558	6,100	106,000	9,858	30'
Exhibit Hall C3	10,320	556	6,090	106,000	9,858	30'
Exhibit Hall C4	8,412	517	5,490	100,000	9,300	30'
Room or Area	Theater Capacity	Classroom Capacity	Banquet Capacity	Useable Area		Ceiling Height
Meeting Rooms						
C101 Auditorium	396	N/A	N/A	5,163	N/A	13' 10" to 20' 3"
C102 Auditorium	224	N/A	N/A	2,420	N/A	13' 5" to 17' 6"
C103	144	66	60	1,360	126.8	16'
C104	117	54	50	1,164	108.3	16'
C105	194	93	80	1,781	165.6	16'
C106	196	95	80	1,779	165.4	16'
C105/C106	418	207	220	3,560	331.1	16'
C107	247	120	140	2,391	222.3	16'
C108	202	95	90	1,783	165.8	16'
C109	190	88	80	1,719	159.9	16'
C108/C109	405	208	210	3,502	325.7	16'
C110	270	139	130	2,328	216.5	16'
C111	706/660*	290	330	5,138	477.32	30'
C112	803/771*	334	380	5,833	541.89	30'
C113	632/567*	254	320	4,622	429.38	30'
C114	516/460*	244	250	4,138	384.42	30'
C111 - 112	1,410/1,316*	648	840	10,971	1,019	30'
C111 - 113	2,100/1,904*	960	1,200	15,604	1,499	30'
C111 - 114	2,628/2,408*	1,200	1,380	19,742	1,834	30'
C112 - 113	1,380/1,247*	624	1,110	10,466	972	30'
C112 - 114	1,764/1,764*	888	2,010	14,604	1,356	30'
C113 - 114	1,110/1,008*	504	1,110	8,771	814	30'

* Exhibit Hall Chair/Meeting Room Chair

Building C

- 4 Exhibit Halls
- 23 meeting rooms
- 2 Auditoriums
- Georgia Ballroom
- Georgia Ballroom Galleria
- West Plaza

- Amenities**
- FedEx Office
 - Gift Shop

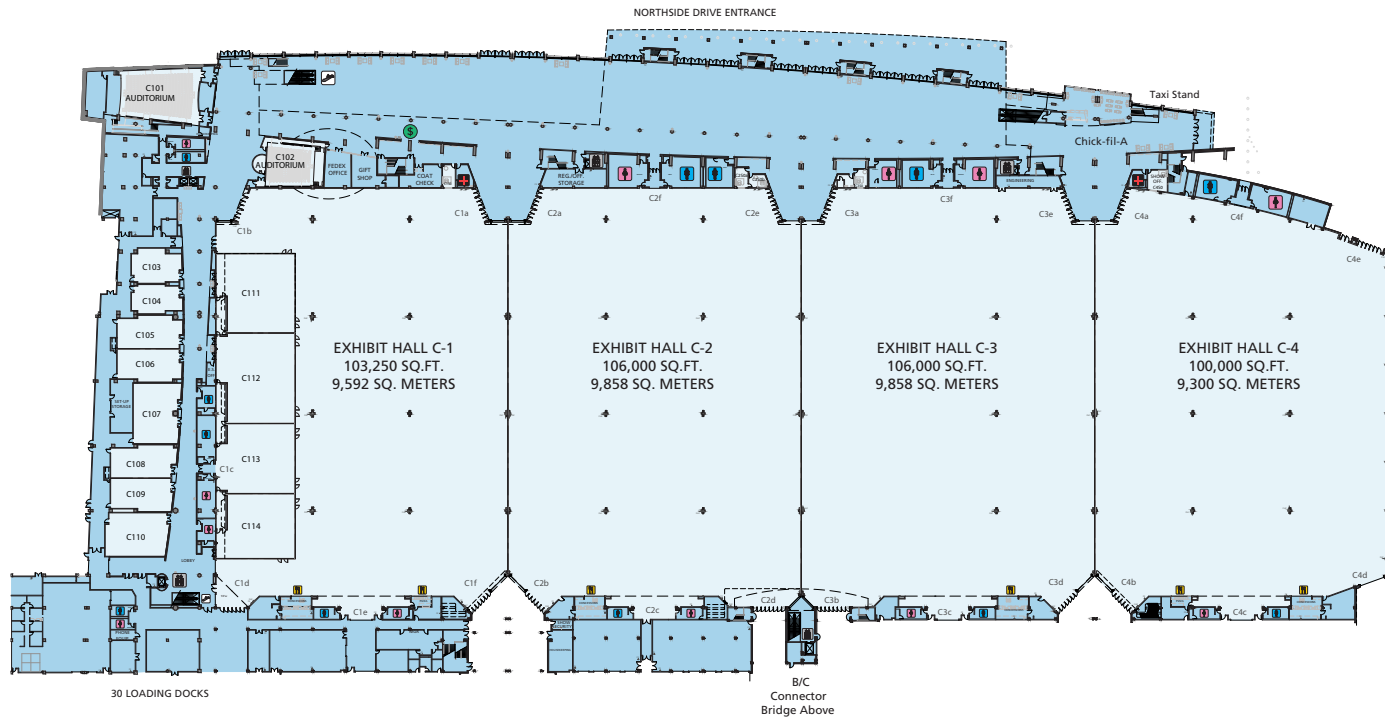
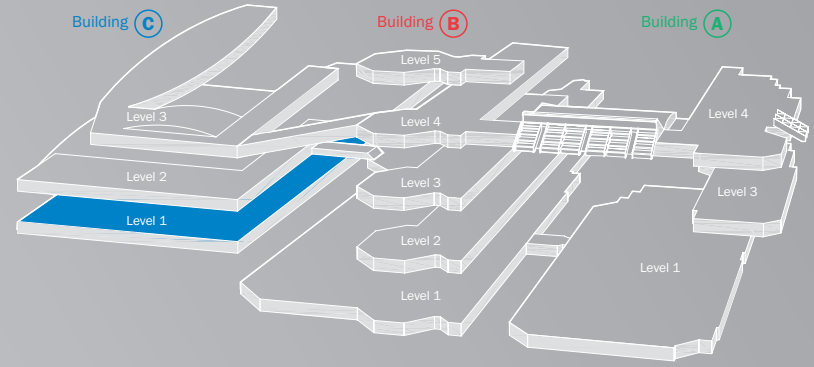

NOTE: Floor plan shown smaller scale.

Room or Area	Theater Capacity	Classroom Capacity	Banquet Capacity	Useable Area		Ceiling Height
				Sq. Ft.	Sq. Meters	
C201	251	135	120	2,342	217.8	14'
C202	178	81	80	1,610	149.7	14'
C203	210	126	120	2,105	195.8	14'
C204	176	81	80	1,610	149.7	14'
C202/C203	472	220	250	3,716	345.5	14'
C203/C204	472	218	250	3,715	345.5	14'
C202-C204	694	330	350	5,326	495.3	14'
C205	251	143	120	2,344	218	14'
C206	294	144	120	2,614	243.1	14'
C207	173	76	70	1,592	148.1	12'
C208	144	70	70	1,430	133.0	12'
C209	140	78	90	1,488	138.3	12'
C210	144	70	70	1,430	133.0	12'
C208/C209	321	159	170	2,918	271.4	12'
C209/C210	321	159	170	2,918	271.4	12'
C208-C210	483	242	240	4,348	404.4	12'
C211	144	70	70	1,430	133	12'
C212	140	78	90	1,488	138.3	12'
C213	144	70	70	1,430	133.0	12'
C211/C212	321	159	170	2,918	271.4	12'
C212/C213	321	159	170	2,918	271.4	12'
C211-C213	483	238	240	4,348	404.4	12'



Notes

.....

.....

.....

.....

Building C

- 4 Exhibit Halls
- 23 meeting rooms
- 2 Auditoriums
- Georgia Ballroom
- Georgia Ballroom Galleria
- West Plaza

- Amenities**
- FedEx Office
 - Gift Shop

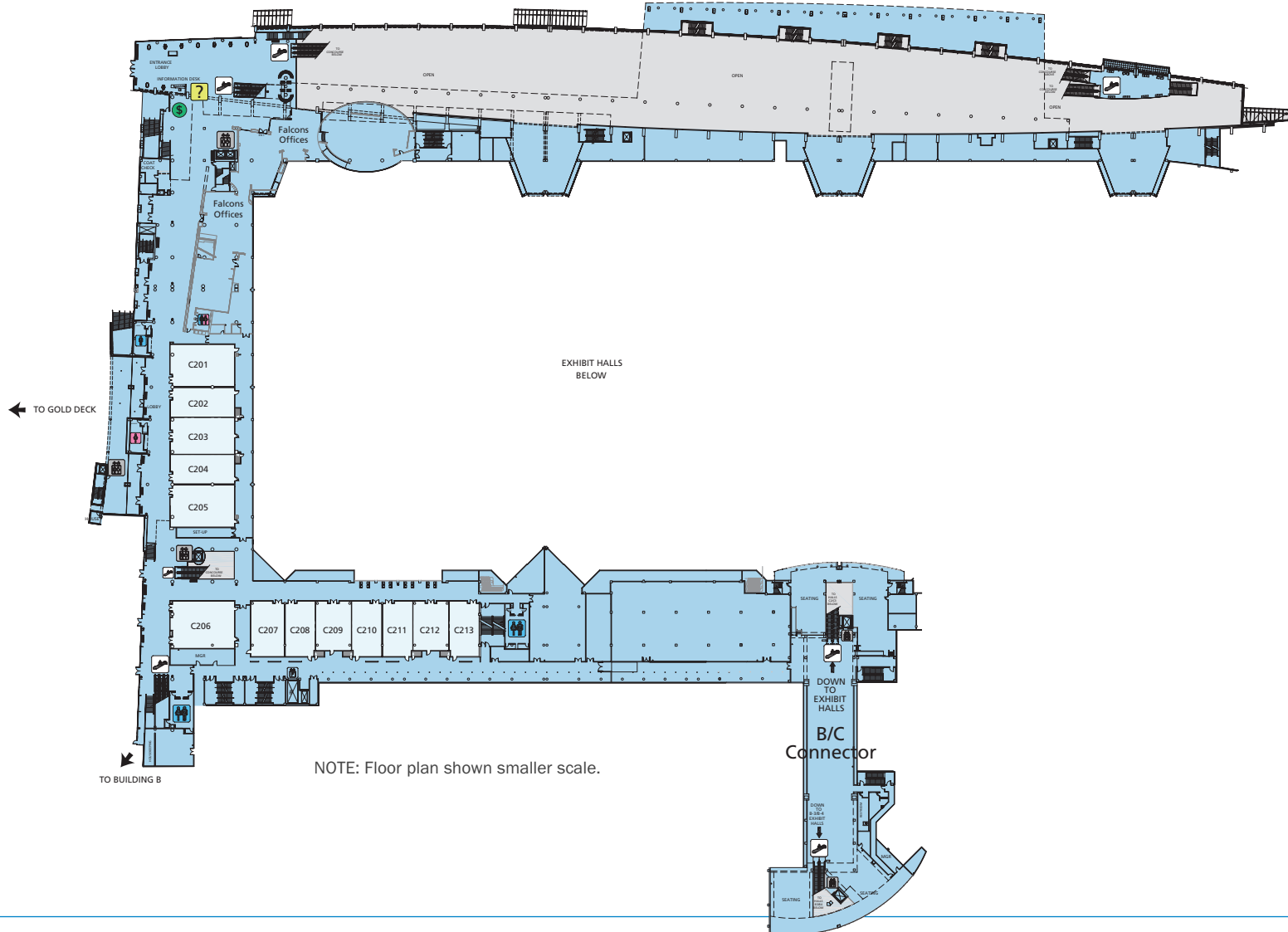
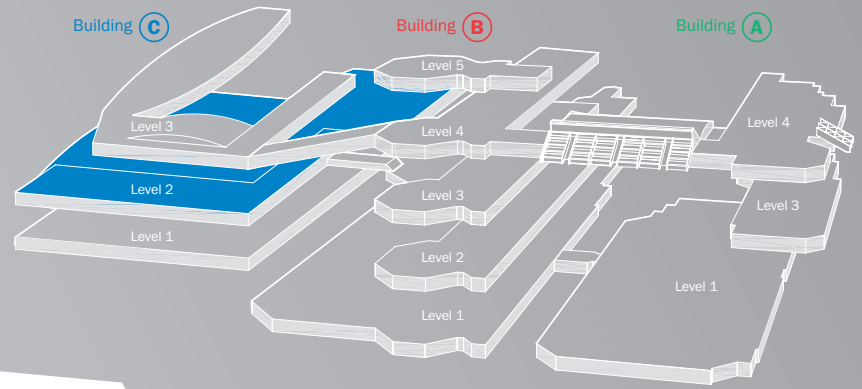

Room or Area	Theater Capacity	Classroom Capacity	Banquet Capacity	Useable Area		Ceiling Height
				Sq. Ft.	Sq. Meters	
Meeting Rooms						
C301	232	124	110	2,288	212.7	16'
C302	385	172	190	3,275	304.6	16'
Ballrooms						
Georgia Ballroom Building C-Sections 1-3	3,600	1,544	2,010	25,722	2,392.1	35'-40'
Georgia Ballroom Building C- Sections 1-2 or 2-3	2,340	1,089	1,240	18,047	1,678.4	35'-40'
Georgia Ballroom Building C-Section 1	940	426	430	7,685	714.7	35'-40'
Georgia Ballroom Building C-Section 2	1,472	714	720	10,378	965.1	35'-40'
Georgia Ballroom Building C-Section 3	940	426	430	7,685	714.7	35'-40'



Building C

- 4 Exhibit Halls
- 23 meeting rooms
- 2 Auditoriums
- Georgia Ballroom
- Georgia Ballroom Galleria
- West Plaza

- Amenities**
- FedEx Office
 - Gift Shop

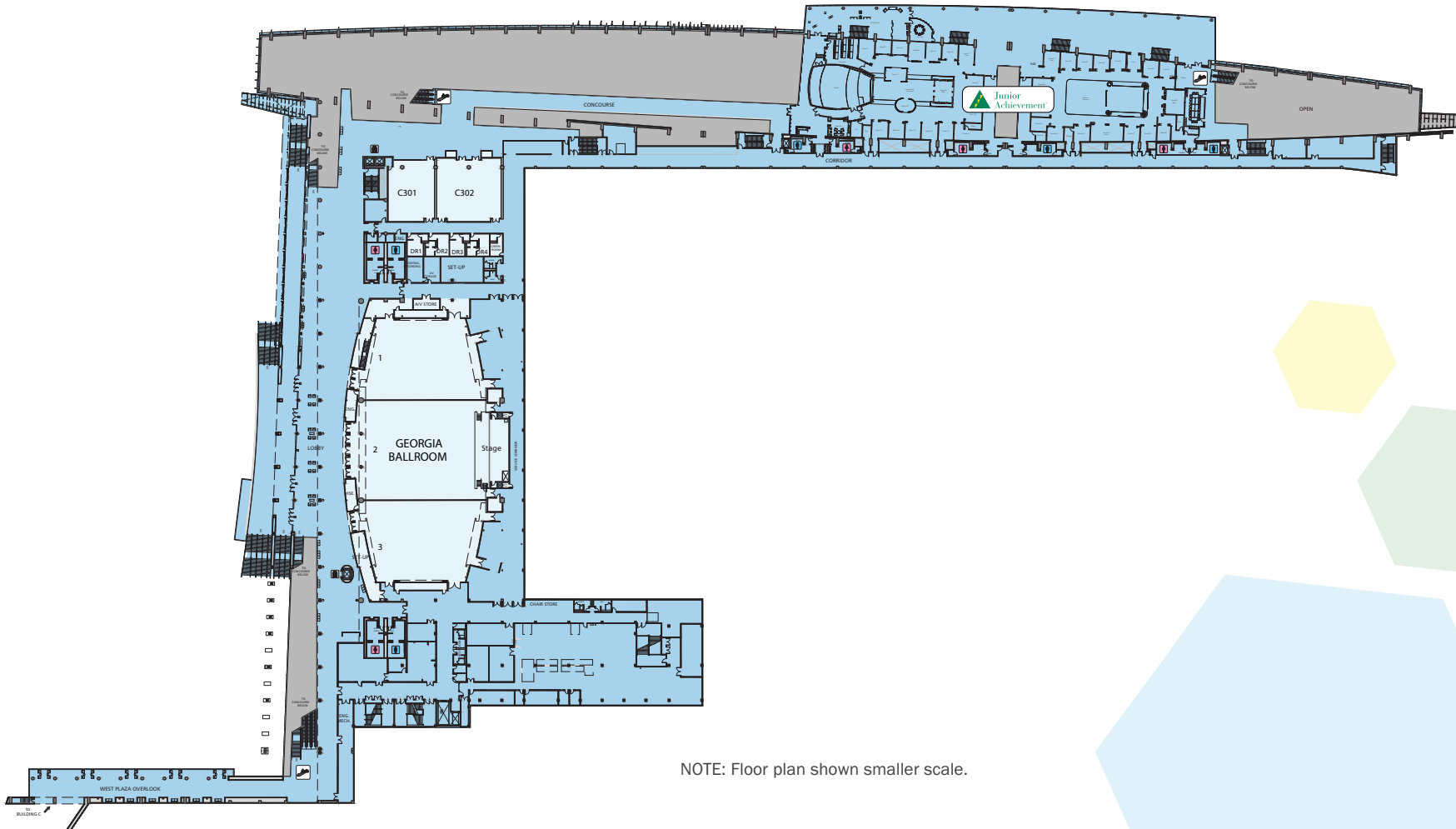
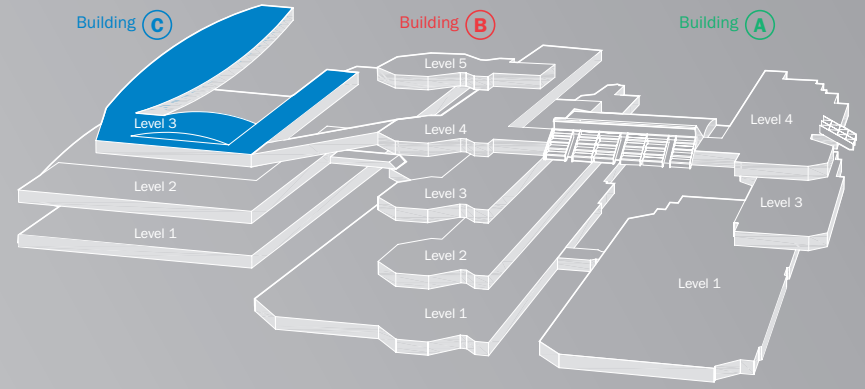

NOTE: Floor plan shown smaller scale.

Centennial Olympic Park

Garden Pavilion North
Garden Pavilion East
Southern Company Amphitheater
Great Lawn



- 21-acre park commemorating the 1996 Centennial Olympic Games
- Links the GWCC and Mercedes Benz Stadium to Atlanta's downtown hotel, business and entertainment district
- Includes the 1,200 person capacity Southern Company Amphitheater
- Six-acre Great Lawn provides natural seating for 20,000
- Regularly scheduled music and entertainment events
- Reflecting pool and water gardens
- Famous Fountain of Rings features a sound system plus synchronized music, water and light displays
- Ideal for receptions, reunions and similar special events





Centennial Olympic Park



Georgia World Congress Center Authority

gwcca.org



Georgia World Congress Center

gwcca.org/gwcc



Centennial Olympic Park

gwcca.org/park